



# NACTA CONFERENCE PROGRAM

June 21-24, 2016  
Honolulu, Hawai'i



## Officers and Regional Directors

### President

**Tracy Hoover**  
Pennsylvania State University

### President-Elect

**Tracy Dougher**  
Montana State University

### Immediate Past President

**Bonnie Walters**  
University of Wisconsin – River Falls

### Secretary/Treasurer

**Marilyn Parker**  
Rupert, Idaho

### Journal Editor

**Rick Parker**  
Rupert, Idaho

### Historian

**Kevin Donnelly**  
Kansas State University

### Membership Director

**Jeannette Moore**  
North Carolina State University

### Canadian Regional Director

**Dana Penrice**

### Central Regional Director

**Lyle Westrom**  
University of Minnesota, Crookston

### Eastern Regional Director

**Lurline Marsh**  
University of Maryland Eastern Shore

### Eastern Regional Director-Elect

**John Ewing**  
Pennsylvania State University

### Western Regional Director

**Bill Hoch**  
Montana State University

### Western Regional Director-Elect

**Ingelia White**  
Windward Community College

### Southern Regional Director

**David Jones**  
North Carolina State University

### Southern Regional Director-Elect

**Nick Fuhrman**  
University of Georgia

## NACTA Committee Chairs & Liaisons

### Journal Committee/Editorial Board

**Rick Parker**  
Rupert, Idaho

### Journal Awards Committee

**Crystal Allen**  
University of Illinois

### Membership and Public Relations Committee

**Jeannette Moore**  
North Carolina State University

### Educational Issues and Teaching Improvement Committee

**Kimberly Moore**  
University of Florida

### Teacher Recognition Committee

**Wendy Warner**  
North Carolina State University

### International Committee

**Laura White**  
New Mexico State University

### Nominating/Distinguished Educator/Foundation Advisory Committee

**Bonnie Walters**  
University of Wisconsin – River Falls

### Murray Brown Leadership Award Committee

**Tracy Dougher**  
Montana State University

### Delta Tau Alpha

**Elizabeth Walker**  
Missouri State University

### NACTA Judging Contest Liaison

**Lyle Westrom**  
University of Minnesota, Crookston

### APLU/CRERR/APD Liaison

**Jean Bertrand**  
University of Georgia

### NARRU Liaison

**Billye Foster**  
Tennessee Tech University

### CFAVM & CADAP Liaison

**Kent Mullinix**  
Kwantlen Polytechnic University

### CAPICU Liaison

**Ed Brokaw**  
Abilene Christian University

### Program Chair and Host Committee 2016

**Jean Bertrand**  
University of Georgia

### Program Chair and Host Committee 2016

**Charles Kinoshita**  
University of Hawai'i at Mānoa

### Program Chair and Host Committee 2017

**Dennis Buckmaster**  
Purdue University



# NACTA 2016 Conference Sponsors



COLLEGE OF TROPICAL AGRICULTURE  
AND HUMAN RESOURCES  
UNIVERSITY OF HAWAII AT MĀNOA



UNIVERSITY  
of HAWAII  
SYSTEM



MONSANTO  
HAWAII  
imagine®



BEERLAB  
HAWAII

## COLLEGE OF TROPICAL AGRICULTURE AND HUMAN RESOURCES PEOPLE, PLACE, PROMISE SINCE 1907



**A Meaningful Experience**, CTAHR's annual fall tour for students, offers a chance to see a neighbor island, bond with each other, gain team-building skills, and explore cultural and agricultural sites. Students have visited tea farms, macadamia orchards, cattle spreads, taro lo'i and seahorse ranches as well as black sand beaches and historic venues.

# Welcome to NACTA 2016

Aloha kākou—welcome to Hawai'i!

The College of Tropical Agriculture and Human Resources (CTAHR) is the founding college of the 10-campus University of Hawai'i System, our state's only public institution of higher education and the principle unit carrying out the tripartite land-grant mission of teaching, research and Cooperative Extension. Through 26 research and extension stations on 5 islands, we serve an ethnically diverse client base that is separated by ocean channels.

Agriculture isn't the first thing that pops into most people's minds when they think about Hawai'i, but it has a long history here. Native Hawaiians were expert aquaculturalists and farmed both sweet potato and dry- and wet-land taro. Westerners harnessed the islands' year-round temperate climate and plentiful rainfall to grow sugar and pineapple. Today we promote diversified agriculture, sustainable resource management and, like the earliest inhabitants, resilient communities.

Hawai'i farms are small—most under 50 acres and generating less than \$50,000 a year in sales. The cost of farming is high and the demand for land insatiable. We import 85 percent of what we eat while struggling to keep invasive species out. Like communities across North America, we worry about wide-ranging issues from food safety to energy security, farm practices to biotechnologies and environmental threats to vulnerabilities of our citizens.

The bright news for all of us is that enrollments are up and career opportunities are strong in agriculture and related programs nationally. Young people want to make a positive difference. NACTA and conferences like this allow us to share the very best in educational practices and curricula so that we equip them to do so.

My best wishes for a productive conference and enjoyable stay in our Island home.



**Maria Gallo, PhD**  
Dean and Director for Research and Cooperative Extension  
College of Tropical Agriculture and Human Resources  
University of Hawai'i at Mānoa

## Table of Contents

Campus Center Map	6
Schedule	8
Wed. Presentations	12
Wed. Posters	17
Thurs. Posters	26
Thurs. Presentations	34
Fri. Presentations	37
Workshops	44

# University of Hawai'i at Mānoa Campus Center 2<sup>nd</sup> Floor

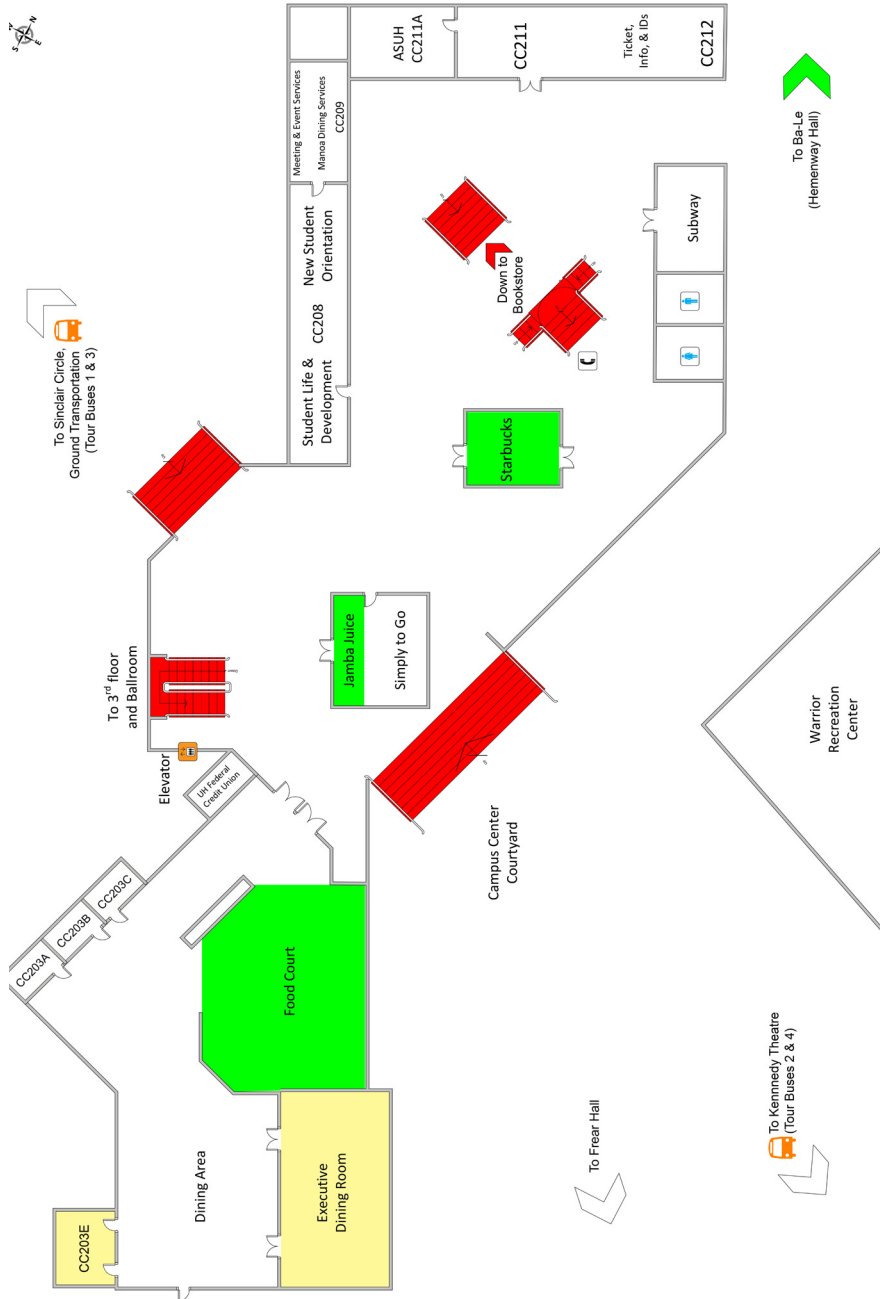

# University of Hawai'i at Mānoa Campus Center 3<sup>rd</sup> Floor

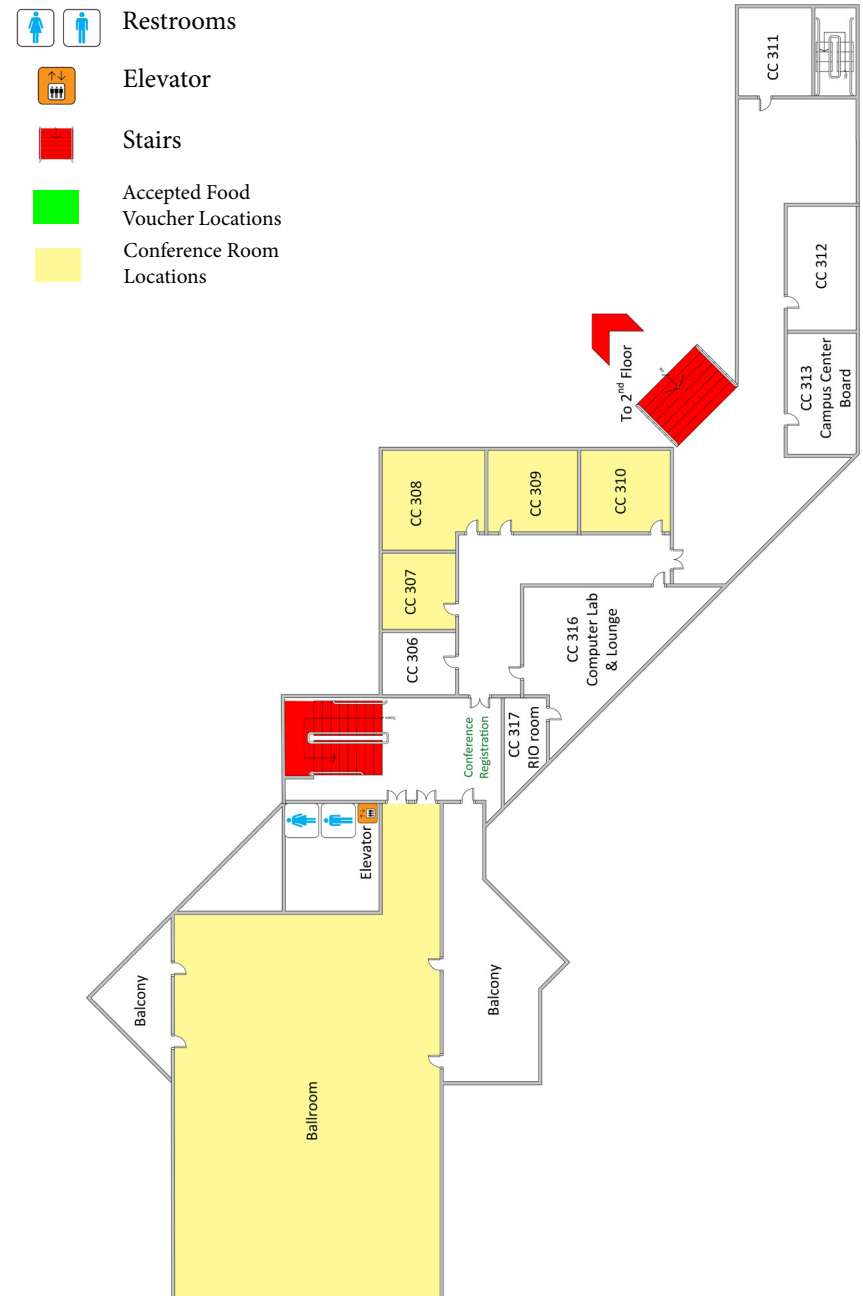

## Schedule

### 6.21 tuesday

#### 10 a.m. - 3 p.m.

Registration  
ALA MOANA HOTEL AND  
FREAR HALL

#### 11 a.m. - 3 p.m.

NACTA Executive  
Committee Meeting  
UHM CC 307

#### 4:30 - 6:30 p.m.

Registration  
KAPI'OLANI COMMUNITY  
COLLEGE

#### 4:45 p.m.

Buses Depart  
ALA MOANA HOTEL AND  
FREAR HALL TO KAPI'OLANI  
COMMUNITY COLLEGE

#### 5:30 - 7:30 p.m.

Welcome Reception  
KAPI'OLANI COMMUNITY  
COLLEGE

#### 7:30 p.m.

Buses Depart  
KAPI'OLANI COMMUNITY  
COLLEGE TO ALA MOANA  
HOTEL AND FREAR HALL

### 6.22 wednesday

#### 7:00 a.m.

Bus Departs  
ALA MOANA HOTEL TO UHM

#### 7:30 a.m. - 3 p.m.

Registration/Information  
UHM CAMPUS CENTER  
BALLROOM FOYER

#### 7:30 - 8 a.m.

Breakfast  
UHM CAMPUS CENTER  
BALLROOM

#### 8 - 9:30 a.m.

Opening Session  
UHM CC BALLROOM  
Welcome and  
Introduction

Dr. Charles Kinoshita  
*Associate Dean of Academic  
and Student Affairs, College of  
Tropical Agriculture and Human  
Resources, University of Hawai'i  
at Mānoa*

Keynote Address  
*Systems, Complexity,  
and Adaptation: The  
Educator's Challenge*

Kyle Datta  
*Ulupono Initiative*

#### 9:30 - 9:45 a.m.

Break

#### 9:45 a.m. - 12 p.m.

Concurrent Presentations 1  
UHM CAMPUS CENTER

1A: Innovative Teaching  
EXECUTIVE DINING ROOM

1B: Innovative Teaching  
CC 203E

1C: Learning Outcomes  
CC 307

1D: Other Educational  
Topics  
CC 308

1E: Scholarly Research  
CC 309

1F: Scholarly Research  
CC 310

#### 12 - 1 p.m.

Lunch (Vouchers)  
UHM CAMPUS CENTER  
Vouchers valid for  
Campus Center's 2<sup>nd</sup>  
Floor Food Court, Jamba  
Juice and Starbucks or  
Ba-Le in Hemenway Hall

#### 1 - 3:10 p.m.

Poster Session 1  
UHM CAMPUS CENTER  
BALLROOM

1 - 2:05 p.m.

Poster Session 1A

2:05 - 3:10 p.m.

Poster Session 1B

#### 3:30 p.m.

Buses Depart  
UHM TO ALA MOANA HOTEL

#### 5:15 p.m.

Buses Depart  
ALA MOANA HOTEL AND  
FREAR HALL TO WINDWARD  
COMMUNITY COLLEGE

#### 6 to 9 p.m.

Lū'au (Hosted by the  
Agripharmatech Program  
and Chancellor's Fund)  
WINDWARD COMMUNITY  
COLLEGE

#### 9 p.m.

Buses Depart  
WINDWARD COMMUNITY  
COLLEGE TO ALA MOANA  
HOTEL AND FREAR HALL

## Schedule

### 6.23 thursday

#### 7:00 a.m.

Buses Depart  
ALA MOANA HOTEL TO UHM

#### 7:30 a.m. - 12 p.m.

Registration/Information  
UHM CAMPUS CENTER  
BALLROOM FOYER

#### 7:30 - 8 a.m.

Breakfast  
UHM CAMPUS CENTER  
BALLROOM

#### 8 - 10:10 a.m.

Poster Session 2  
UHM CAMPUS CENTER  
BALLROOM

8 - 9:05 a.m.

Poster Session 2A

9:05 - 10:10 a.m.

Poster Session 2B

#### 10:10 - 10:25 a.m.

Break

#### 10:25 a.m. - 11:40 a.m.

Concurrent Presentations 2  
UHM CAMPUS CENTER

2A: Innovative Teaching  
EXECUTIVE DINING ROOM

2B: Innovative Teaching  
CC 203E

2C: Learning Outcomes  
CC 307

2D: Other Educational  
Topics  
CC 308

2E: Other Educational  
Topics  
CC 309

2F: Scholarly Research  
CC 310

#### 11:40 - 12:30 p.m.

Box Lunch  
PICK UP AT UHM CAMPUS  
CENTER BALLROOM OR  
OUTSIDE JAMBA JUICE

#### 12:30 p.m.

Tour Buses Depart  
LEAVE UH FOR TOURS

#### 12:30 - 6 p.m.

Tours (Refer to tour ticket)  
VARIOUS LOCATIONS ON  
O'AHU; BUSES RETURN TO  
ALA MOANA HOTEL AND UH



#### IT'S A FACT:

Most of Hawai'i's  
7,000 farms are  
small—63% are  
less than 10 acres,  
and 88% are less  
than 50 acres.

### ABOUT THE KEYNOTE SPEAKER

**Kyle Datta** is General Partner of Ulupono Initiative, a for-profit, impact investment firm that works to improve the quality of life in Hawai'i by making sustainable investments in locally produced food, renewable energy, and waste reduction. Mr. Datta previously was CEO of the privately funded U.S. Biodiesel Group, Managing Director of Research and Consulting at the Rocky Mountain Institute, and Vice President at Booz Allen Hamilton, in charge of Asia energy and U.S. utilities practice.

Mr. Datta holds master's degrees in public and private management and environmental science in resource economics from the Yale University. He is co-author of the RMI books *Winning the Oil End Game* and *Small is Profitable* and serves on the board of directors for Blue Planet Foundation, Hawai'i BioEnergy, and Parker Ranch.

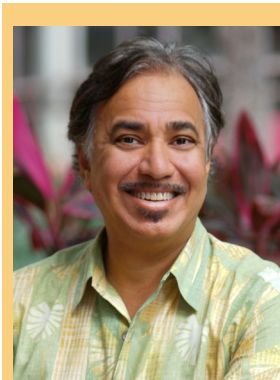

**Kyle Datta**  
General Partner  
ulupono  
INITIATIVE

## Schedule

6.24 *friday*

**7:00 a.m.**  
Buses Depart  
ALA MOANA HOTEL TO UHM

**7:30 - 9 a.m.**  
Registration/Information  
UHM CAMPUS CENTER  
BALLROOM FOYER

**7:30 - 9 a.m.**  
Breakfast / NACTA  
Committee Meetings  
UHM CAMPUS CENTER  
BALLROOM

**9 - 10 a.m.**  
Blue-Ribbon Presentation  
UHM CAMPUS CENTER  
BALLROOM

Introduction  
Dr. Tracy S. Hoover  
*Associate Dean for  
Undergraduate Education,  
College of Agricultural Sciences,  
The Pennsylvania State  
University*

Blue-Ribbon Address  
*Millennials and Me*  
Dr. Ann Marie  
VanDerZanden  
*Iowa State University*

**10 - 10:15 a.m.**  
Break  
UHM CAMPUS CENTER

**10:15 a.m. - 12 p.m.**  
Concurrent Presentations 3  
UHM CAMPUS CENTER

3A: Innovative Teaching  
EXECUTIVE DINING ROOM

3B: Innovative Teaching  
CC 203E

3C: Innovative Teaching  
CC 307

3D: Learning Outcomes  
CC 308

3E: Other Educational  
Topics  
CC 309

3F: Scholarly Research  
CC 310

**12 - 1:30 p.m.**  
NACTA Business Luncheon  
UHM CAMPUS CENTER  
BALLROOM

**1:30 - 2:45 p.m.**  
Concurrent Presentations 4  
UHM CAMPUS CENTER

4A: Innovative Teaching  
EXECUTIVE DINING ROOM

4B: Innovative Teaching  
CC 203E

4C: Innovative Teaching  
CC 307

4D: Learning Outcomes  
CC 308

4E: Other Educational  
Topics  
CC 309

4F: Other Educational  
Topics/Scholarly Research  
CC 310

**2:45 - 3 p.m.**  
Break (Hosted by  
Monsanto Hawai'i)  
UHM CAMPUS CENTER  
BALLROOM

**3 - 5 p.m.**  
Workshops  
UHM CAMPUS CENTER

**#1 Boosting Enrollment:  
Successful Recruitment  
Courses in Food and  
Agricultural Sciences**  
*Sponsored by USDA*  
EXECUTIVE DINING ROOM

## Schedule

6.25 *saturday*

**9 - 12 p.m.**  
NACTA Executive  
Committee Meeting  
ALA MOANA HOTEL

**#2 Teaching Indigenous  
Agriculture: Hawaiian  
Approaches to Integrate  
Tropical Crops and  
Cropping Systems  
in Today's Training  
Programs and Curricula**  
CC 203E

**#3 Quality Seed Variety  
Leads to a Bountiful  
Harvest: A Look at  
Internships**  
CC 307

**#4 Assessment - Not  
a 4-Letter Word!  
Meaningful and  
Manageable Strategies  
for Assessing Student  
Learning Outcomes**  
CC 308

**#5 Advancing Your  
Scholarly Teaching  
into the Scholarship of  
Teaching and Learning  
(SoTL)**  
CC 309

**#6 Strategic Study Abroad  
Course Development and  
Assessment**  
CC 310

**5:30 - 8:30 p.m.**  
Networking and Awards  
Banquet  
UHM CAMPUS CENTER  
BALLROOM

**8:30 p.m.**  
Buses Depart  
RETURN TO ALA MOANA  
HOTEL

### ABOUT THE BLUE RIBBON SPEAKER



**Ann Marie  
VanDerZanden, PhD**

Director, Center  
for Excellence in  
Learning and Teaching

Professor, Department  
of Horticulture

IOWA STATE UNIVERSITY



Ann Marie VanDerZanden, PhD, is a Louis Thompson Distinguished Undergraduate Teacher, Director of the Center for Excellence in Learning and Teaching, and Professor of Horticulture at Iowa State University. As Director, she provides leadership for the center in meeting its mission to support, promote, and enhance teaching effectiveness and student learning at Iowa State.

She has taught more than 25 different courses, and she maintains an active teaching and mentoring role in the Department of Horticulture. Her research interests include many aspects of undergraduate education, which she explores in both the horticulture context and across the university. She is also keenly interested in historic Irish gardens and their preservation and restoration using sustainable landscape practices.

Dr. VanDerZanden has received numerous outstanding teaching awards and positive student evaluations. A favorite recent student comment is, "I didn't like doing the camera challenge assignments, but I know why you made us do them. Thank you." A prolific writer, she has written three landscape textbooks and regularly contributes to national and regional gardening magazines. In addition, she frequently publishes peer-reviewed articles focused on teaching and learning in higher education.

**THE  
VALUES  
OF ALOHA**

**AKAHAI**  
*kindness*

**LŌKĀHI**  
*unity, harmony*

**'ŌLUOLU**  
*pleasantness*

**HA'ĀHA'Ā**  
*humility*

**AHONUI**  
*patience*

### It's All About the 'Ulu



CTAHR Outstanding Alumna **Diane Ragone** is a Star of Oceania for global efforts to promote sustainable agriculture and food security through cultivation of breadfruit.



**Group 1A: Innovative Teaching**  
ROOM CC EXECUTIVE DINING ROOM

TIME	NO.	TITLE	AUTHORS
9:45	403	Utilizing Multi-University Collaboration to Enhance Distance Education Materials for Principles of Professional Selling Courses: A Case Study	<b>Jane Bachelor</b> , University of Florida, Scott Downey, Purdue University, Larry Zink, Michigan State University, & Kerry Litzenberg, Texas A&M University
10:00	384	Enhancing Student Learning in the Hawai'i AgDiscovery Program	<b>Mandy Chen</b> & Charles Kinoshita, University of Hawai'i at Mānoa
10:15	383	Cultivating Student Success Using Interactive Web Tools	<b>Bonnie Walters &amp; Tim Buttles</b> , University of Wisconsin - River Falls
10:30	381	Building Relationships and Trust Between the Local Community and STEM Professionals	<b>Janice Straley</b> , University of Alaska Southeast Sitka Campus, Mary Lou Madden, Madden Associates, & Janet Clarke, Sitka Sound Science Center
10:45	375	A Novel Approach to Teach Sustainable Animal Breeding and Genetics Practices to Undergraduates in the Animal Sciences	<b>Kyle C. Caires</b> , Berry College, GA
11:00	372	Implementation of Agroecology Summer Institutes for Secondary Teachers in South Texas	Alexis Racelis & <b>Tim Sears</b> , University of Texas, Rio Grande Valley
11:15	371	Should Social Media Education be a Part of the Agronomy Curriculum?	<b>Marshall M. Hay</b> & Kim J. Kerschen, Kansas State University
11:30	365	Teaching Healthy Lifestyles and Science to Youth by Building and Cooking from World-Regions Gardens	<b>Mary Martini</b> , Lehua Wall, & Kaya Terem, University of Hawai'i at Mānoa
11:45	345	Teaching Apparel Construction in a Flipped Classroom <b>(CANCELLED)</b>	<b>Samii Kennedy Benson</b> , Balitore City Community College

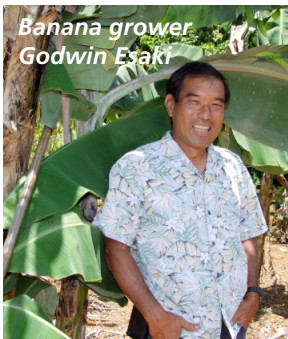

Banana grower  
Godwin Esaki



**THE FACE OF FARMING IN HAWAII**

Half of Hawai'i farm operators are Asian-American, 8% are Native Hawaiian/Pacific Islanders, and 9% are mixed race. More than 1 in 4 are women. Close to a third are over age 65. Two-thirds live on their farms, but nearly half say farming is *not* their primary occupation.

**Group 1B: Innovative Teaching**  
ROOM CC 203E

TIME	NO.	TITLE	AUTHORS
9:45	326	Incorporating the Smartphone as a Teaching Tool for Agronomic Education	<b>Marshall M. Hay</b> & Kevin J. Donnelly, Kansas State University
10:00	312	Cultivating Graduate Student Success: Integrating Natural and Social Sciences to Promote Interdisciplinary Research and Teaching	<b>Melanie Miller Foster</b> & Maria Jimenez-Gasco, The Pennsylvania State University
10:15	304	Generation Us: Teaching Methods	<b>Kelly V. Johnson</b> & Kathi Jogan, University of Arkansas
10:30	303	Increasing the Utility Value of Lab Reports in a College Biology Course	<b>Kevin Curry</b> , Dan Spencer, Ondrej Pesout, & Kimberly Pigford, North Carolina State University
10:45	298	Swapping the Bar for the Bed: Using Biofeedback as a Teaching Method for Developing Professional Resilience and Readiness in College Students	<b>Erica B. Thieman</b> & Blaze K. Currie, University of Illinois at Urbana-Champaign
11:00	288	Using Animation Technology in Teaching Social Justice to Collegiate Agriculture Students	<b>Pamala Morris</b> , Shalyse Iseminger, & George Takahashi, Purdue University, IN
11:15	281	Engaging Students' Emotions and Logic to Address Wicked Problems	<b>Nicole Stedman</b> & Jera Niewoehner, University of Florida
11:30	260	Using Art to Evaluate Student Views of Insect-Person Interactions in an Undergraduate Entomology Course	<b>W. Wyatt Hoback</b> , J. Shane Robinson, Bill D. Cavill, & Doug Golick, Oklahoma State University
11:45	258	Gathering Women to Cultivate Agriculturally Empowered and Engaged Learning	<b>Melissa Leiden Welsh</b> , Shannon Potter Dill, & Jennifer Rhodes, University of Maryland Extension

**Group 1C: Learning Outcomes**  
ROOM CC 307

TIME	NO.	TITLE	AUTHORS
9:45	392	Global Perspective Certificate Program: Assessment Using a Faculty Development Rubric	Barbara M. Kirby & <b>Michael D. Mullen</b> , North Carolina State University
10:00	388	Do We Still Believe in The Power of Knowledge?	<b>Nataliya Plesha</b> , University of Connecticut, & Stephen Devadoss, University of Idaho

TIME	NO.	TITLE	AUTHORS
10:15	361	Engaging Agriculture Students in Reflective Discourse Around Intercultural Communication: Approaches and Outcomes	<b>Jera Niewoehner</b> & Nicole Stedman, University of Florida
10:30	343	Cultivating Solar Energy Experiences: Evaluation of a Hands-on Workshop	<b>Edward A. Franklin</b> , University of Arizona
10:45	310	An Evaluation of the Implementation and Use of College-Level Standards in Undergraduate Research in a College of Agricultural and Life Sciences	<b>Amanda L. Ford</b> , <b>Allen F. Wysocki</b> & Wendy J. Dahl, University of Florida
11:00	290	Perceptions Concerning Instructor's Attempts to Motivate or Challenge Students Using the IDEA Student Evaluation	<b>Mark J. Anderson</b> , M.M. Beverly, J.L. Leatherwood, K.J. Stutts, & S.F. Kelley, Sam Houston State University, TX
11:15	218	Financial Analysis of FFA Career Development Events Hosted by Texas A&M University-Commerce for 2012-2014	<b>Chelsea Arnold</b> , Robert L. Williams, & Erin Fortenberry, Texas A&M University - Commerce
11:30	283	Interdisciplinary EAAT Course Assessment	<b>Kathi Jogan</b> & Kelly V. Johnson, University of Arkansas
11:45	16	Focus on Efficiency ( <i>NEW TIME</i> )	<b>Boykin Witherspoon III</b> , California State University - San Bernardino

#### Group 1D : Other Educational Topics

ROOM CC 308

TIME	NO.	TITLE	AUTHORS
9:45	399	Meeting the Grand Challenges	<b>Timothy J. Nichols</b> , <b>Suzanne Stluka</b> , & Henry Goeden, South Dakota State University
10:00	373	Improving Student Success through the Undergraduate Advising Experience	<b>Timothy Kerr</b> & Dennis Buckmaster, Purdue University, IN
10:15	367	Assessing the Impact of Vertical Alignment Professional Learning Communities in Improving Teacher Instructional Approaches	<b>Maria Navarro</b> , Tim Foutz, & Emily Cabrera, University of Georgia
10:30	355	Assessing the Potential for Establishing 4-H in Belize to Preserve Agricultural Indigenous Knowledge and Practices	<b>Olivia Murphy-Sweet</b> , Melanie Miller-Foster, Daniel Foster, & Paige Castellanos, The Pennsylvania State University
10:45	338	Perceptions of a Diverse Student Population on Animal Agriculture	<b>Kyle J. Stutts</b> , S.F. Kelley, J.L. Leatherwood, M.M. Beverly, & M.J. Anderson, Sam Houston State University, TX

TIME	NO.	TITLE	AUTHORS
11:00	330	A BRIDGE Program to Engage, Sustain and Empower Women and Minorities in STEM	<b>Semih Aslan</b> , Michelle Londa, Bahram Asiabanpour, Jesus Jimenez, & Hassan Salamy, Texas State University
11:15	329	Advantages and Challenges in Academic Advising Approaches Utilized by Various Size Agricultural Universities	<b>Charles Robert Stark Jr.</b> , University of Arkansas, Joey Mehlhorn, University of Tennessee, & Randy Little, Mississippi State University
11:30	320	Student Recruitment: What Is It That REALLY Makes Them Say "Yes!"?	<b>Dwayne Pavelock</b> , Shyam Nair, Savannah Koehl, & Bethany Whitten, Sam Houston State University, TX
11:45	24	Are Agriculture Students Prepared for a Global Marketplace?	<b>Melissa Hendrickson</b> , Elizabeth Wilson, Jay Jayaratne, & Wendy Warner, North Carolina State University

#### Group 1E : Scholarly Research

ROOM CC 309

TIME	NO.	TITLE	AUTHORS
9:45	382	Classroom Level Student Engagement in a Team-Based Learning Formatted Course	<b>OP McCubbins</b> , Thomas. H. Paulsen, & Ryan Anderson, Iowa State University
10:00	360	Describing Perceptions of Preparedness Among Agriscience Educators Entering 21st Century, Global, Learning Environments	<b>Carla Jagger</b> & M. Susie Whittington, The Ohio State University
10:15	200	Exploring the Connection: Linking Leadership Skill Development with Curricular Experiences	<b>Jonathan J. Velez</b> & Aaron J. McKim, Oregon State University
10:30	322	Building Professional Learning Networks Through Social Media: #TeachAgChat	<b>Daniel Foster</b> , Melanie Miller Foster, The Pennsylvania State University, & Karen Cannon, University of Nebraska
10:45	299	Describing Agricultural Discipline Specific Signature Pedagogies	<b>Laura L. Rice</b> & Daniel D. Foster, The Pennsylvania State University
11:00	294	Balancing Expertise: Responsive Approach to Conservation Curriculum Development in a Secondary Agricultural Educational Setting	Elena Polush, Jose I. Martinez, Ball State University, <b>Thomas H. Paulsen</b> , Iowa State University, & Taylorann K. Clark, Odebolt-Arthur and Battle Creek-Ida Grove H.S.
11:15	239	Foundational Components of a Student Teaching Experience	<b>David C. Frazier</b> , Sheridan Mulkey, T. Wayne Atchley, & Rudy Tarpley, Tarleton State University, TX
11:30	266	The Not So "Ugly American:" How Study Abroad Enhances Students' Professionalism Skills	Ann Martin, William Moore, <b>Gary Wingenbach</b> , Tobin Redwine, Tracy Rutherford, Texas A&M University, & Wash Jones, Prairie View A&M University



TIME	NO.	TITLE	AUTHORS
11:45	376	Examining the Differences in Learning Style Preferences for College of Agriculture Students <i>(NEW TIME)</i>	<b>Kasee L. Smith</b> & John Rayfield, Texan A&M University

**Group 1F : Scholarly Research**  
ROOM CC 310

TIME	NO.	TITLE	AUTHORS
9:45	232	TPACK to GPACK? The Examination of the Technological Pedagogical Content Knowledge Framework as a Model for the Integration of Global Content into College of Agriculture Classrooms	Emily Urban & <b>Maria Navarro</b> , University of Georgia
10:00	226	The Influence of a Social System on Students' Understanding of Global Food Security	<b>Robert Strong Jr.</b> , Thomas Hall IV, & Katlin Keppler, Texas A&M University
10:15	212	"Exploring Food Security" Crop Science Short-Term Study Abroad Program: Student Participants' Motivations and Concerns	<b>Amber Lynn Beseli</b> & Lori J. Unruh Snyder, North Carolina State University
10:30	204	Will Mom Approve? Parent Perceptions of Study Abroad Programs	<b>Tracy Rutherford</b> , David Walther, Tobin Redwine, Gary Wingenbach, Texas A&M University, Laura Lemons, Holly Webb, Mississippi State University, J.C. Bunch & Joey Blackburn, Louisiana State University
10:45	192	A Pre-Post Perspective on Individual and Team Scores in a Team-Based Learning Course	<b>Foy D. Mills Jr.</b> , L.A. Wolfskill, Shyam S. Nair, & Jaclyn Robinson, Sam Houston State University, TX
11:00	175	Team Cohesiveness and Its Influence on Student Performance in Team-Based Learning	Shyam S. Nair, Foy D. Mills, Jr., <b>L. Art Wolfskill</b> , & Jaclyn Robinson, Sam Houston State University, TX
11:15	151	Are We Focusing on the Right Things? Perceptions of Recent Graduates	<b>Daniel D. Foster</b> , John C. Ewing, Mark Threeton, & Nur Husna Abd Wahid, The Pennsylvania State University
11:30	139	Perceived Gap Between Importance and Competence of Leadership Characteristics Among Undergraduate Leadership Students	<b>Ben Weikert</b> , Laura Hasselquist, & Jon C. Simonsen, University of Missouri
11:45	13	Incorporating STEM in a Natuculture Laboratory for Teaching Agriculture and Non-Agriculture Students	Manuel Reyes, <b>Paula E. Faulkner</b> , Alexander Joyce, & Michelle Nelson, North Carolina A&T State University

wednesday 1-2:05 p.m. *Poster Session 1A*

NO.	TITLE	AUTHORS
409	Embedding Professional Development into a Problem-Based Transdisciplinary Obesity Prevention Course	<b>Brenda Koester</b> , Jill Bowers, Jennifer Themanson, Barbara Fiese, Gabriella Garcia, University of Illinois at Urbana-Champaign, Dorothy Teegarden, Purdue University, & Amber Hammons, California State University at Fresno
98	An Instrument to Determine Teachers' Perceptions of College and Career Readiness: 21st Century Knowledge, Skills, and Dispositions (21st C-KSD)	<b>Catherine A. DiBenedetto</b> , Clemson University, & Brian E. Myers, University of Florida
406	Cultivating Student Success Through a Global Issues Course	<b>Amber Lynn Beseli</b> & Elizabeth Wilson, North Carolina State University
405	Six Ways to Discuss	<b>Roger Brown</b> , University of Kentucky, & Sara Williamson, Saint Joseph's University, Philadelphia, PA
395	Utilizing the Hardiness Approach in an Undergraduate Leadership Course in Agricultural and Life Sciences	Hannah Carter, <b>Elio Chiarelli</b> , & Michele Curts, University of Florida
389	Students as Co-Producers of Teaching and Education: Role of Service-Learning	<b>Nataliya Plesha</b> & Adam N. Rabinowitz, University of Connecticut
374	The Impact of Undergraduate Students' Perceived Efficacy on Academic Performance in an Animal Nutrition Course	<b>Katherine A. Moore</b> , C.R. Phillips, M.S. Aschenbrener, S.P. Doyle, & K.L. DeAtley, California State University-Chico
369	Experiential and Experimental Learning Approaches in Agriculture Sciences at Florida International University	<b>Krish Jayachandran</b> , Mahadev Bhat, & Kateel Shetty, Florida International University
364	Teaching Sustainable Gardening by Modeling a Family-Sustaining System	<b>Mary Martini</b> , University of Hawai'i at Mānoa
359	Innovative and Scholarly Approaches to Train Minority Students in Research on Spatial and Temporal Patterns at the Chesapeake Bay and Hilo Bay	<b>Shobha Sriharan</b> , Virginia State University, Gulnihal Ozbay, Delaware State University, & Jason Adolf, University of Hawai'i at Hilo
358	Maximizing Language Learning Abroad: Exploring The Case of the Agricultural Spanish Program at The Adventure Education Center in Turrialba, Costa Rica	Kayla Hack, Melanie Miller Foster, Daniel Foster, & <b>Paige Castellanos</b> , The Pennsylvania State University
350	Factors Impacting Student Situational Interest in an Equine Science Learning Module	<b>Elise A. Lofgren</b> , Colleen Brady, & Judith Lewandowski, Purdue University, IN

NO.	TITLE	AUTHORS
344	Campus CSA and Farm Market: Tools for Teaching Crop Production and Developing New Farmers	<b>Ann Emmsley</b> , Pedro Oliveros, & Lyons Cabacungan, University of Hawai'i, Maui College
340	Innovations for Improving Writing Skills of First-Year Students in the Agricultural Technology Program at Virginia Tech	<b>Joseph W. Guthrie</b> , Virginia Tech
339	Creating Infographics as an Educational Teaching Tool in Two Iowa State University Animal Science Classes	<b>Jodi Sterle</b> , Amy Powell, & Kelly Schulz, Iowa State University
336	Engaging Students through Various Teaching Methods: Experiences from an Introductory Tropical Ornamental Horticulture Course for Non-Majors	<b>Orville C. Baldos</b> , University of Hawai'i at Manoa
335	Poster Presentations: Combining Communication, Research and Creative Skills for Undergraduate Students	<b>Joy E. Morgan</b> & Jim Flowers, North Carolina State University
380	Comparing Exam Options for Assessment of Student Learning	<b>Chad L. Gasser</b> , Southern Utah University
379	Identifying and Changing Perspectives of Agriculture: A Case Study	<b>Kasee L. Smith</b> & John Rayfield, Texas A&M University
377	Impact of Course Delivery Method (Online vs Traditional) and Semester (Fall vs Spring) on Final Grades in a Freshman Animal Science Course Over a Six Year Period	<b>Kimberly Ange-van Heugten</b> , North Carolina State University
353	Comparison of Classroom and Field Learning Environments: A Look at Student Learning and Enjoyment	<b>Erik J. Christian</b> , Haleigh Summers, & Katharina Wigg, Iowa State University
342	Improving the Delivery and Content of an Online Plant Science Lab Course by Assessing Learning Outcomes	<b>James McConnell</b> , Mari Marutani, & Jason Andrew, University of Guam
289	Variables that Affect Retention Rates in the Agricultural Institute at North Carolina State University	<b>Alyssa Degreenia</b> , Elizabeth Wilson, Wendy Warner, David Jones, & Karl Jicha, North Carolina State University
337	Successes and Failures: Academic/ Graduation Results Over Time for Developmental Students Enrolled in a Small State University Agriculture Program	<b>Charles Robert Stark, Jr.</b> , University of Arkansas- Monticello
313	Using Field Trip Reports to Assess Students' Critical Thinking in a Freshman Plant Science Class	<b>Lurline Marsh</b> & Fawzy Hashem, University of Maryland - Eastern Shore
305	Enhancing Students' Personal Growth with a Study-Aboard Program in Food Science	<b>Maria Navarro</b> , Isis Vera Blanco, Quint Newcomer, & Ronald B. Pegg, University of Georgia

NO.	TITLE	AUTHORS
302	Fern Propagation: An Experiential Learning Component	Eman I. Gabour, <b>Sharadchandra P. Marahatta</b> , Kaua'i Community College, & Ashly Trask, National Tropical Botanical Garden
300	Environmental Literacy and Student Performance: Lessons Learned from a Professional Development Intervention	<b>Kevin Curry</b> , Rachel Szczytko, Kathryn Stevenson, Wendy Warner, & Travis Park, North Carolina State University
316	Professional Development Needs of Traditionally vs. Alternatively Certified High School Agriculture Teachers	Meagan Pasket, <b>Dwayne Pavelock</b> , & Doug Ullrich, Sam Houston State University, TX
394	English as the Instructor's Second Language: A Barrier to the Teaching Learning Process	<b>Mike McDermott</b> , Eastern Kentucky University
390	Gaining Farmers' Perspective on Climate Change	<b>Kaila Thorn</b> , The Pennsylvania State University
378	The Softer Side of STEM: Agricultural Sciences Students' Perception of the Role of "Soft Skills" in Their Educational and Career Success	<b>Olga Bolden-Tiller</b> , Tuskegee University, AL
368	A Comparison of Students' Career Aspirations and Decisions Before and After Completion of an Introduction to Agricultural Communications Course	<b>Troy Tarpley</b> & C. Akers, Texas Tech University
357	Technology Evolution: The Incorporation of ZipGrade into your Technology Toolbox	<b>A. Bechtold</b> , L. Hayes, R. Ramanathan, B. Wilson, Dan Stein, Oklahoma State University, & S. Lowman, Southeast Missouri State University
354	Hort Plants: An iOS App for Teaching About Landscape Plants	<b>Dharmendra Saraswat</b> & J. Robbins, Purdue University, IN
333	Evolution of a Summer Enrichment Program in Agriculture for High School Students	<b>Christopher Catanzaro</b> , P. Thomas-Buchanan, & S. Bradshaw, Virginia State University
319	Is Success in Leadership Development Events Simply a Numbers Game?	<b>Dwayne Pavelock</b> , Shyam Nair, Savannah Koehlj, & Doug Ullrich, Sam Houston State University, TX
407	Examining How Place Attachment Affects Citizen Perspectives of Albizia	<b>Candace Wharton</b> , Hawai'i Community College, Hilo, HI
348	Predictors of Career Decision-Making Self-Efficacy Among Female College Freshmen and Transfer Students	<b>Torrie A. Cropps</b> , Brandon Allen, Abby Coy, & Levon T. Esters, Purdue University, IN
309	The Effect of Student Motivation on Performance in Online Exams	<b>Mark J. Anderson</b> , S.F. Kelley, M.M. Beverly, K. J. Stutts, & J.L. Leatherwood, Sam Houston State University, TX

NO.	TITLE	AUTHORS
236	Keeping International Program REAL: Real World Applications within Limitations	<b>David C. Frazier</b> , T. Wayne Atchley, & Rudy Tarpley, Tarleton State University, TX
277	Grounding the New/Beginning Urban Farmer: Identifying Gaps in Educational Resources	<b>Allyson Schonfeld</b> , Daniel D. Foster, & John C. Ewing, The Pennsylvania State University
264	Students Use Portfolios to Gauge Effort and Achievement in a Plant Identification Course	<b>Cynthia Haynes</b> , Jan Thompson, Suzanne Hendrich, Jan Wiersema, Barbara Licklider, & Samantha Green, Iowa State University
262	A Holistic Evaluation of Supplemental Instruction in Introductory Science Courses on Student Learning and Success	<b>Greg Pillar</b> , Jennifer Daniel, Sydney Dishman, Fred DeAngelis, Shariva White, & Beth Stuart, Queens University of Charlotte, NC
363	Strengthening Student Engagement and Inter-campus Collaboration Through Community Connections in Hawai'i	<b>Daniela Dutra-Elliott</b> , Ann Emmsley, Sharadchandra Marahatta, & William Sakai, Leeward Community College
397	Hands-on Learning Contributes to Non-traditional Student Success in Natural Resources Management and Agriculture	<b>Pamela Y. Scheffler</b> , & Orlo C. Steele, Hilo Community College, Hilo, HI
83	A Celebration of Diversity: Heritage Plants	<b>William S. Sakai</b> , Zoe Banfield, Heather Coad, Nahoku Kahana, Risa Kabua Miyazoe, Jeffrey Yong, Russell Shiohita, & Marcia Y. Sakai, University of Hawai'i, Hilo, HI
352	Learning Management Systems to Improve Online Access for Students of the College of Agricultural Sciences-University of Puerto Rico-Mayaguez	<b>Esbal Jimenez</b> & Gladys Gonzalez, University of Puerto Rico
231	Utilizing Focused Atmosphere Seminars for Improvement of Career and Leadership Readiness of Women in Agriculture	<b>Julie Weathers, Samantha Lowman</b> , & David Mauk, Southeast Missouri State University
408	Mapping Pedagogy, Learning Outcomes, and Effect Size in Effective Educational Programming	<b>Victor Harris</b> , Brad Sewell, Christina Collingwood, & Sarah Ellis, University of Florida
400	The Purdue Arboretum's Native Nursery Supports and Extends Experiential Student Learning	<b>Paul Siciliano</b> , Purdue University
387	Taking Student Learning Styles in Course Development and Classroom Design	<b>Govind Seepersad</b> , Shivani Seepersad, The University of the West Indies, Dave Goorahoo, & Florence Cassel S., California State University - Fresno
385	Incorporating Entrepreneurship and Experiential Learning in Agriculture Courses	<b>Dave Goorahoo</b> , Florence Cassel S., California State University, Govind Seepersad, & Shivani Seepersad, University of the West Indies

NO.	TITLE	AUTHORS
349	Forensic Laboratory and Active Learning Assignments Expose Minority and First Generation Students to Agricultural Programs	<b>Trevor Stamper</b> , Purdue University, IN

wednesday 2:05–3:10 p.m. *Poster Session 1B*

NO.	TITLE	AUTHORS
334	Cultivating Student Success Through Diverse Experiences	<b>Joy E. Morgan</b> & Wendy J. Warner, North Carolina State University
325	"Flipping" Towards Alternative Careers in Animal Science	<b>Kamilah E. Grant</b> & Olga Bolden-Tiller, Tuskegee University
323	Expanding Global Learning Opportunities: The Development of a Pennsylvania State Youth Global Food Security Institute	Nicole Weaver, Twin Valley School District, <b>Daniel Foster</b> , & Melanie Miller Foster, The Pennsylvania State University
321	Animal Science Instructors' Perception of Abilities and Capabilities of their Students	<b>Crystal A. Allen</b> & W.L. Hurley, University of Illinois at Urbana-Champaign
332	Connecting Students to Hawaiian Culture through Alaskan Ethnobotany	<b>Ann Emmsley</b> , Pedro Oliveros, & Lyons Cabacungan, University of Hawai'i, Maui College
296	Digital Tools to Teach Chemistry in Agriculture	<b>April Ulery</b> , Laura White, Barbara Chamberlin, Jeanne Gleason, & Nicholas Beltran, New Mexico State University
341	Impacts of Mediasite Classroom Capture on Attendance and Final Grades in the Freshmen Course Introduction to Companion Animals	<b>Kimberly Ange-van Heugten</b> , North Carolina State University
278	Using the "Infomercial" as an Educational Tool	<b>Mike Amstutz</b> & Karen Bennett-Wimbush, Ohio State University ATI
274	Building Ecological Literacy through Challenge-Based Instruction and Culturally Relevant Pedagogy	<b>Alexis Racelis</b> , University of Texas - Rio Grande Valley
255	Increasing Youth Involvement in Agriculture, Food, and Natural Resources through Extension Support in Formal Education	<b>Robert T. Bass</b> , Sarah Morton, & James Anderson, Virginia Tech
169	Distribution Methods of Result Demonstration Results by County Extension Agents in Texas	<b>Whit H. Weems</b> , T. Wayne Atchley, G. Curtis Langley, Rudy S. Tarpley, Tarleton State University, TX, & Jeff Ripley, Texas A&M Extension

NO.	TITLE	AUTHORS
250	Gridiron Challenge: Utilizing Sport as an Educational Platform to Reduce Cultural Gaps in Colleges of Agriculture	<b>Kristina Ricketts, Bryan Hains,</b> & Glenn Faulkner, University of Kentucky
248	Sunn Hemp as a Model Plant for Experiential Teaching and Learning	<b>Christina L. Martiney,</b> Sharadchandra P. Marahatta, Kaua'i Community College, Kevin Johnson, Kauai High School, & Ashly Trask, National Tropical Botanical Garden
247	Teaching Science, Technology, Engineering and Mathematics through Agriculture, Food and Natural Resources	<b>Neil A. Knobloch</b> & Hui-Hui Wang, Purdue University, IN
243	Forensic Plant Pathology: Enhancing U.S. Crop Biosecurity Through Multidisciplinary Graduate Education, Experience and Research	J. Fletcher, L.M. Ma, <b>Francisco Ochoa-Corona,</b> U. Melcher, C. Garzon, W. Schneider, A. Wayadande, & R. Allen, Oklahoma State University
240	Using Snapchat to Cultivate Feedback and Facilitate Engagement amongst Millennials	Brooke Prather, Tracy Rutherford, & <b>Holli R. Leggette,</b> Texas A&M University
307	Effect of Teaching Platform on Student Performance and Motivation	<b>Mark J. Anderson,</b> S.F. Kelley, M.M. Beverly, J.L. Leatherwood, & K.J. Stutts, Sam Houston State University, TX
228	Utilizing an Experiential Learning to Develop Curriculum Modules <b>(CANCELLED)</b>	Michael S. Retallick, Iowa State University, & <b>Alisen M. Anderson,</b> Northeastern Oklahoma A&M College
284	Measuring Student Outcomes in an Animal Handling Class	<b>Kathi Jogan</b> & Andrew Fidler, University of Arkansas

NO.	TITLE	AUTHORS
276	Evaluation of an Online Master of Food Technology (MFT) Degree Program and Associated Courses	<b>Lauren K. Hudson,</b> Mark A. Harrison, & Judy A. Harrison, University of Georgia
268	Students Predicting and Reflecting on their Achievement in a Plant Identification Class	<b>Samantha Green</b> & Cynthia Haynes, Iowa State University
267	Mind Yourself: A Case Study in Celebrating Self-Management Skills	William Moore, Ann Martin, <b>Gary Wingenbach,</b> Tobin Redwine, Tracy Rutherford, Texas A&M University, & Wash Jones, Prairie View A&M University
253	Assessment of the Bioenergy Minor at Oregon State University	<b>Micki Halsey-Randall,</b> Darlene Russ-Eft, Zhenglun Li, & Katharine G. Field, Oregon State University
115	Utilizing a Modified Photo-elicitation Technique to Teach Complex Agricultural Concepts	<b>Jennifer Strong,</b> Texas A&M University
223	Usefulness of an Online Writing Improvement Tool for Agricultural Communications Courses	<b>Leia Flure</b> & Lulu Rodriguez, University of Illinois at Urbana-Champaign
209	Students' Perceptions regarding the Use of Technology in an Introductory Food Science Class	Ranjith Ramanathan, J. Shane Robinson, Deb L. VanOverbeke, Gretchen G. Mafi, & <b>Dan Stein,</b> Oklahoma State University
199	Effects of Animated Content on Students' Perceptions of Learning in a Web-Based Animal Disease Course	<b>Derek Mosier,</b> Jessica Green, Kent Nelson, Mal Hoover, Valerie York, Kansas State University, Gayle Brown, Kevan Flaming, & Jesse Hostetter, Iowa State University
189	High School Students' Career Motivation and Views of Agriculture upon Completion of a Pre-College Agricultural Sciences Program	Kaylie Scherer, <b>Neil Knobloch,</b> Amy Jones, & Myron McClure, Purdue University, IN
188	Evaluating Impact of an Electronic Communication Tool to Manage Insect Pests on Peppermint	<b>Marvin Butler,</b> Darrin Walenta, Clare Sullivan, Nicole Anderson, & Ralph Berry, Oregon State University
180	Effects of the iVetSchool Application on Veterinary Medical Students' Food Animal Knowledge	<b>Matt Raven,</b> Robert Malinowski, Robert Linford, Kent Ames, Jon Patterson, Jennifer Roberts, & Ann Rashmir-Raven, Michigan State University
318	Leadership Styles of Successful FFA Advisors and FFA Programs	<b>Dwayne Pavelock,</b> Zach Nowak, & Doug Ullrich, Sam Houston State University, TX
404	Clarity and Accuracy in Plagiarism Policies at Land Grant Institutions	<b>Roger Brown</b> & Alissa Rossi, University of Kentucky
297	Awareness and Utilization of On Campus Student Services for First Year Students	<b>Cecil Shelton</b> & Alyssa Bumbaugh, The Pennsylvania State University

**COLLEGE OF TROPICAL AGRICULTURE AND HUMAN RESOURCES**  
PEOPLE, PLACE, PROMISE SINCE 1907



**ENVIRONMENTAL LEADERSHIP**

CTAHR student and UH Mānoa Sustainability Coordinator **Kristen Jamieson** made the 2016 Hawai'i Sustainability in Higher Education Summit a zero-waste event, earning a commendation from Hawai'i Gov. David Ige.

Four CTAHR dietetics students started a UH Food Recovery Network chapter and teamed up with campus food services to reduce waste and provide unused food to homeless shelters.



NO.	TITLE	AUTHORS
295	Impact of Community Viability Grants on Education	Sarah Bush, Dana Hogg, <b>Robert Bass</b> , & <b>Rick Rudd</b> , Virginia Tech
285	Experiential Learning: Preparing Agriculture Majors for the Agriculture Workforce	<b>Paula E. Faulkner</b> , Taylor Johnson, North Carolina A&T State University, Jacques Surrency, & Archie Williams, Fort Valley State University
141	An Examination of Sustainability Behavioral Patterns of Students at Texas State University	<b>Douglas Morrish</b> , Dexter Wakefield, & Justin Pulley, Texas State University
273	Effectiveness of Online Instruction	<b>Indi Braden</b> , Southeast Missouri State University
270	Undergraduate Agricultural Business and Agricultural Economics Programs: How do we Identify?	Jeffrey Gillespie & <b>Maria Bampasidou</b> , Louisiana State University
256	Academic Entitled: What do Students and Faculty Think?	Donna L. Graham & <b>Leslie D. Edgar</b> , University of Arkansas
222	Public Speaking: Do Curriculum Opportunities Enrich Oral Communication of Undergraduates?	<b>Courtney A. Crist</b> & Susan E. Duncan, Virginia Tech
215	Recruiting Online: A Student Perspective of Social Media Use for Recruitment	<b>Lauri M. Baker</b> , Brooke Harshaw, & Kristina Boone, Kansas State University
211	Food Science Exploration Program for Outreach to High School Students	<b>Adrienne E.H. Shearer</b> & Kalmia E. Kniel, University of Delaware
259	Effectiveness of Course-Embedded Research to Address Multiple Student Learning Outcomes in an Analytical Chemistry Course	<b>Greg D Pillar</b> , Queens University of Charlotte
229	Long-term Impacts of a Faculty Development Program for the Internationalization of Curriculum in Higher Education	Emily Urban & <b>Maria Navarro</b> , University of Georgia
221	The Influence of Pre-College Experiences on Students' Decision to Enroll at Tarleton State University	Wayne Atchley, <b>Ryan Smith</b> , Randy Harp, & Rudy Tarpley, Tarleton State University, TX
190	Human-Animal Interactions in an Educational Setting Influence Student Heart Rate	<b>Kimberly Cole</b> & Kelly George, The Ohio State University
133	Secondary Agricultural Education Student Injuries and Other Accidents Sustained In An Agricultural Mechanics Laboratory	<b>A. Preston Byrd</b> , Clemson University, SC, <b>Ryan G. Anderson</b> , Iowa State University, & P. Ryan Saucier, Sam Houston State University, TX
172	Assessment of Student Scores in Agricultural Mechanics Career Development Events: An Investigation into Students Knowledge Base	<b>Justin Pulley</b> , Texas State University, G. Curtis Langley, Tarleton State University, TX, & Joe Muller, Sam Houston State University, TX

NO.	TITLE	AUTHORS
238	Madison Teaching and Learning Excellence: An Innovative Early-Career Faculty Development Program at University of Wisconsin-Madison	<b>Nick J. Balster</b> , Megan Schmid, & Chris Castro, University of Wisconsin-Madison
351	CEEZAD BSL-3 Training/Transboundary Animal Diseases Summer Program	<b>Jessica L. Green</b> , J. Webster, S. Hober, & J.A. Richt, Kansas State University
331	Increase Industry Involvement in Dynamic Engineering Education	<b>Semih Aslan</b> , Michelle Londa, & Bahram Asiabanpour, Texas State University
308	Developing Research Skills in Undergraduate Students to Facilitate Admission and Success in Graduate Programs in Agriculture, Food and Related Sciences, University of Puerto Rico-Mayaguez	<b>Gladys M. González</b> , Ángel L. González, & Abner Rodríguez, University of Puerto Rico
293	SOFT and the Noelani First Grade Gardeners	<b>Tiele-Lauren Doudt</b> , Mitchell Loo, Thomas Lim, Theodore Radovich, Kathleen Sturgeon, & Lianne Morita, University of Hawai'i
271	Using a Flipped Classroom to Facilitate Course-Related Student Research	<b>Holly A.S. Dolliver</b> , University of Wisconsin - River Falls

**COLLEGE OF TROPICAL AGRICULTURE AND HUMAN RESOURCES**  
PEOPLE, PLACE, PROMISE SINCE 1907



**ENVIRONMENTAL CHALLENGE**

Isolation and speciation have given Hawai'i an unusually high number of unique species. Many, including the Pulelehua or Kamehameha butterfly, are in decline. CTAHR student **Colby Maeda** monitors predation on eggs and larvae to find out why. He has won two best poster awards at the college's Student Research Symposia. His advisor heads the Pulelehua Project, which engages citizen scientists in reporting butterfly sightings to help create a statewide habitat map.



*Caterpillar hunter  
Colby Maeda*

NO.	TITLE	AUTHORS
207	Panic at the Potluck: Design and Implementation of a Web-based Game	<b>Kalmia E. Kniel</b> , Adrienne E. H. Shearer, Dallas G. Hoover, University of Delaware, David Abraham, Pamela Martinez, & Barbara Chamberlin, New Mexico State University
203	Teaching Quantitatively Rigorous Courses to Biology Students: A 'Semi-Flipped Classroom' Approach	<b>Madan Oli</b> , Jennifer Moore, & Elise Morton, University of Florida
196	Developing Students' Questioning Ability	<b>Mike Amstutz</b> , Karen Bennett-Wimbush, & Casey Meek, Ohio State University - Agricultural Technical Institute
191	Combining Reflective and Reflexive Journaling as a Tool for Technical Skill Development	Mallory Mobly, <b>Tobin Redwine</b> , & Tracy Rutherford, Texas A&M University
182	Establishing the Pipeline to Recruiting Minorities in Agricultural Education: A Phenomenological Approach in an Urban School in Illinois	<b>Dexter Wakefield</b> , Texas State University
174	Innovative Use of GoogleDocs™ to Engage High School and University Students in Experiential Learning using a Simulation Game	<b>L. Art Wolfskill</b> , Shyam S. Nair, & Foy D. Mills, Jr., Sam Houston State University, TX
162	Experiential Learning through Field Practice in an Undergraduate Crop Science Classroom	<b>Erin K. Bosch</b> & Michael W. Everett, Michigan State University
160	Integrating High-Impact Learning Experiences: Teaching Agricultural Leadership to Inmates at a Local Federal Prison	<b>Robert Strong Jr.</b> , Texas A&M University
156	A Comprehensive and Interdisciplinary Approach to Teach International Agriculture	<b>Sathya Elavarthi</b> , Marikis Alvarez, Delaware State University, & Lurline Marsh, University of Maryland - Eastern Shore
152	Developing Team-Oriented Tactical Skills in Crisis Planning and Management within an Established Agvocacy Course	<b>Don Mulvaney</b> , Auburn University, AL, & Virginia Morgan-White, Alabama Extension System
142	Empowering Students as Industry Ambassadors	<b>Carrie L. Pickworth</b> & Wendy J. Warner, North Carolina State University
138	Utilizing the Group Member Role Questionnaire to Assign Students to Teams	<b>Jennifer Strong</b> , Texas A&M University, & Laura Lemons, Mississippi State University
127	Integrative Stem in Urban Communities	<b>Sarah J. Morton</b> & Kathleen A. Jamison, Virginia Tech

NO.	TITLE	AUTHORS
125	Cultivating Experiential Learning: Insights into the role of the Farm Operator on the Ag450 Farm	<b>Gregory Vogel</b> , Andrew 'OP' McCubbins, & Thomas H. Paulsen, Iowa State University
121	When Life Can Imitate Art: Using Theatre of the Oppressed in Youth Leadership Programs to Enhance Critical Awareness and Community Agency	<b>Erika Pioltine Anseloni</b> & Mark Brennan, The Pennsylvania State University
237	Cultivating Communication Style to Prepare Agricultural Communicators for Employment	<b>Holli R. Leggette</b> , Theresa P. Murphrey, & Stacey Dewald, Texas A&M University
110	Focusing on Partnerships for Faculty-Led Study Abroad Programs: Examples from Pennsylvania State University's Ag2Americas Initiative	<b>Paige Castellanos</b> , Melanie Miller Foster, & Ketja Lingenfelter, The Pennsylvania State University
109	Cultivating Professional and Engaging Social Media Voices	Holly Jarvis Whitaker & <b>Holli R. Leggette</b> , Texas A&M University
107	Teaching in Innovative Spaces: Curriculum That Complements the Space	<b>Maria L. Stewart</b> , University of Hawai'i at Mānoa, HI
103	Therapy Dogs Helping Students Reduce Stress	Kristie Franks, <b>Stanley F. Kelley</b> , & Marcy M. Beverly, Sam Houston State University, TX
173	The LEADERS Program: Encouraging Hispanic Students to Pursue Advanced Degrees in Animal Science	<b>Kim McCuiston</b> , Randy Stanko, Texas A & M University, & Clint Loest, New Mexico State University
153	Relationships between Psychological Type and Leadership Perceptions in Undergraduate Leadership Students	<b>Kevin D. Herndon</b> , Tracy Kitchel, & Jon C. Simonsen, University of Missouri
149	Is Class Size in an Introduction to Sustainability Course Related to Student Self-Efficacy?	<b>Michael W. Everett</b> & Matt R. Raven, Michigan State University
146	Educational Value of Human-Animal Interactions	<b>Kelly A. George</b> & <b>Kimberly Cole</b> , The Ohio State University
145	Agripharmatech Program Certificates: Pathways for Transfer to Four Year Higher Education Institution and Beyond	Charles Kinoshita, <b>Donna Kuehu</b> , & Ingelia White, University of Hawai'i at Mānoa, HI
134	Evaluation of Student Outcomes and Takeaways from a Food Microbiology Course	<b>Lauren K. Hudson</b> , Mark A. Harrison, & Judy A. Harrison, University of Georgia
131	Laboratory Management Professional Development Needs of Iowa Secondary Agricultural Education Teachers	P. Ryan Saucier, Sam Houston State University, TX, <b>A. Preston Byrd</b> , Clemson University, SC, & Ryan G. Anderson, Iowa State University
119	Self-Efficacy and Career Commitment as Predictors of Achievement in a Food Chemistry Course	Donald M. Johnson, <b>Catherine W. Shoulders</b> , Corliss A. O'Bryan, & Philip G. Crandall, University of Arkansas

NO.	TITLE	AUTHORS
117	You Could Do Better: Developing Improved Outcomes for Global Education Programs	<b>Noel B. Habashy</b> , The Pennsylvania State University
210	Student Expectations and Perceptions of Graduate and Undergraduate Teaching Assistants in Laboratory Classes	<b>Chelsea Ahlquist</b> , Kim Kerschen, & Kevin Donnelly, Kansas State University
185	Exposing Undergraduate Students to the Extension Mission of Land Grant Universities Using a Course Field Trip	<b>Chad Miller</b> , Cheryl Boyer, & Allison Teeter, Kansas State University
164	Predicting Perceived Major Fit Among College Freshmen and Transfer Students	<b>Abby N. Coy</b> , Brandon C. Allen, Torrie A. Cropps, & Levon T. Esters, Purdue University, IN
159	Factors Influencing Freshmen's Decision to Major in Agriculture	<b>Amy Jones</b> , Tracie Egger, Dennis Buckmaster, & Levon Esters, Purdue University, IN
154	Agricultural Networking Night: An Alternate Career Development Activity	<b>Christina Clark</b> & Robert Williams, Texas A & M University - Commerce
140	Southwest Agriculture and Food Security Education (SAFE): Filling the Gaps of Underrepresentation	<b>Douglas Morrish</b> & Dexter Wakefield, Texas State University
137	STEP UP to USDA Career Success Program Participation Increased Graduation Rates and Final GPA of Undergraduate Agriculture Students from South Texas	<b>Randy L. Stanko</b> , Shad D. Nelson, Tanner J. Machado, Greta L. Schuster, Consuelo Donato-Molina, & Steven Lukefahr, Texas A&M University
179	Factors That Influenced Students to Attend Tarleton State University and Enroll In the College of Agricultural and Environmental Sciences	<b>Wayne Atchley</b> , Justin McGriff, Randy Harp, Rudy Tarpley, & Lea Ann Kinman, Tarleton State University, TX
130	The Children's Healthy Living Summer Institute: An Opportunity for Sustained Pacific Workforce Capacity Development	<b>Marie K. Fialkowski</b> , R. Novotny, M.K. Esquivel, A. Eichelberger, W. Meinke, H. Ngo, C. Kahalewale, T. Delormier, University of Hawai'i at Mānoa, HI, & J. Leslie, University of Hawai'i at Hilo, HI
129	Experiential Learning Experience of MSP Scholars	<b>Guochen Yang</b> , Louis Jackai, & Joshua Idassi, North Carolina A&T State University
123	EWE-TH CONNECT: A Curriculum for Educating Wyoming Youth about the Sheep Industry	<b>Whit H. Weems</b> , Cody Ann Bainter, T. Wayne Atchley, & Rudy S. Tarpley, Tarleton State University, TX
102	Adapting the Forest Management Planning Process to an Educational Plan Development at Virginia's Middleburg Agricultural and Research Extension Center	<b>Dylan E. Dawson</b> , Carolyn A. Copenheaver, Adam K. Downing, & Kim L. Niewolny, Virginia Tech
282	Urban Agritourism as an Educational Venue Addressing Local Food Insecurity	<b>Bryan Hains</b> , <b>Jamie Yunker</b> , & Kristina Ricketts, University of Kentucky

NO.	TITLE	AUTHORS
112	Clarifying the Operationalization of Agricultural Literacy	<b>Guang Han</b> & Robert Martin, Iowa State University
108	Analysis of Identifiers of Vocational Identity of Animal Science Undergraduates	Alicia Schneider, David Rosch, & <b>Walter Hurley</b> , University of Illinois
101	Publication Patterns of Forestry Graduate Students: A Case Study from Virginia Tech	<b>Carolyn A. Copenheaver</b> , Virginia Tech, & Saskia van de Gevel, Appalachian State University
93	College Students Share Knowledge to Improve Student Attitudes Toward Animal Welfare and Develop Employment Skills	<b>Kimberly A. Cash</b> , B.C. Shanks, M.S. Aruguete, A.L. Bax and L.S. Wilbers, Lincoln University, MO, & J.D. Caldwell, Purina Animal Nutrition Center LLC
89	Impactful Themes of a Leadership Academy Experience	<b>Laura Hasselquist</b> , Ben Weikert, & Jon Simonsen, University of Missouri
57	Prioritizing Pertinent Components of a College-level Bioenergy Curriculum Using the Delphi Technique	<b>Kimi Grzyb</b> , Brian Hartman, & Katharine G. Field, Oregon State University
49	Pre-Course University Student Perceptions of Renewable Energy Sources	<b>Edward A. Franklin</b> , University of Arizona
328	A Campus Seed Share Initiative: Using Local Partnerships and Place-Based Learning to Strengthen Curriculum and Community	<b>Daniela Dutra-Elliott</b> , <b>Natalie Wahl</b> , & Alina Harris, Leeward Community College
193	Evaluating the Impact of a Required Agricultural Mechanics Unit of Instruction on Pre-Service Teachers	<b>Alex Preston Byrd</b> & James A. Thackston, Clemson University, SC
171	Impact of Food Science Professionals on Student Learning in an Academic Setting	<b>Francine H. Hollis</b> , The University of Tennessee, & Fulya Eren, ACH Food Companies, TN
128	Student Retention through Peer Mentoring in the College of Agricultural and Environmental Sciences at The University of Georgia	<b>Victoria David</b> , & Hugo Alexander Morán Chávez, University of Georgia
347	Exploring Innovation with Online Delivery Methods: A Blended Approach	<b>Mary T. Rodriguez</b> , The Ohio State University



### FORGET SUGAR AND PINEAPPLE...

Hawai'i's leading commodity is seed corn, exceeding the \$152 million combined market value of tree nuts and fruit crops, according to the 2012 USDA Census of Agriculture.

In 2014, the state's top vegetable crops were head cabbage (by volume) and cucumbers (by farm gate value.)

NO.	TITLE	AUTHORS
100	Student Perceptions of Immediate Feedback while Taking a Test	Donald M. Johnson & <b>Catherine W. Shoulders</b> , University of Arkansas
94	Outcomes from a Dialogue about Diversity in a Graduate Learning Community	<b>Dustin Grabsch &amp; Summer F. Odom</b> , Texas A&M University
80	Student Learning With and Without Answers to Teaching Allowed Paired Problem Solving	<b>Catlin Pauley</b> , Alfred Conklin Jr., & Monte Anderson, Wilmington College
77	Lights, Camera, Action: Using InterviewStream to Prepare Students for Webcam Job Interviews	<b>Carley Calico</b> & Laura Lemons, Mississippi State University
76	Establishing Study Abroad Programs with Agricultural NGOs for North American Colleges of Agriculture Students to Gain Academic, Experiential and Transformative Knowledge: Opportunities and Challenges	<b>Muthusami Kumaran</b> , University of Florida
65	Alternative Course Formats: A Case for Learning	<b>Melissa Hendrickson, Paulette Campbell</b> , & Ronald Campbell, North Carolina State University
63	Building Global Agricultural Perspectives: Learning Outcomes of a Project Abroad	<b>Laura Hahn &amp; Prasanta Kalita</b> , University of Illinois at Urbana-Champaign
60	The Student Centered Classroom, "Feed Your Microbiome: The New Gut Feeling"	<b>Monika Oli</b> , University of Florida, & Jennifer Lyles, Francis Marion University, SC
59	Fermentation Revival in the Classroom: Ancient Human Practices as Modern Health Fads	<b>Jennifer Lyles</b> , Francis Marion University, SC, & Monika Oli, University of Florida
58	Using Concept Mapping to Facilitate Teaching Abstract Conceptualization and Reflective Observation	<b>Michael S. Retallick</b> & Bryan Rank, Iowa State University
54	Interdisciplinary Learning of Energy through Integration of Socioeconomic Topics	<b>Zhenglun Li</b> & Katharine Field, Oregon State University
50	Learning Communities at Purdue University	<b>John G. Graveel</b> , Purdue University, IN
48	The Mock Well: A Solar Water Pumping Demonstration Project	<b>Edward A. Franklin</b> , University of Arizona
46	Cultivating Student Success Across a Greenhouse Curriculum	Christopher J. Currey, & <b>Ann Marie VanDerZanden</b> , Iowa State University
44	The Value of Exploring Agriculture in the United States	<b>J.L. Stewart &amp; Matt A. Kennedy</b> , Oregon State University

NO.	TITLE	AUTHORS
37	Using Cooperative Learning Groups and Peer Teaching to Combat the Challenges Facing Veterinary Laboratory Courses	<b>Amanda Bowling</b> , David Cross, & Anna Ball, University of Missouri
8	Utilizing "Mystery" Ingredients as a Creative Teaching Tool to Develop Value Added Agricultural Products	<b>Lorna Tsutsumi</b> , Kawehi Lopez, Cheryl Yara, & Brandon Carvalho, University of Hawai'i, Hilo, HI
327	Innovate Approaches to Exploring Climate Change in the Pacific Islands	<b>Terry Nipp</b> , Hauhouot Diambra-Odi, Chris Pangelinan, Mari Marutani, Jim McConnell, & Lee Yudin, University of Guam
144	Collaborative Course Development: An Empirical and Interdisciplinary Investigation	<b>Kasey L. DeAtley</b> , Damon Aiken, James E. Downing, M.E. Matthews, & David E. McCoy, California State University
113	A Pre-Post-Test of Self-Regulated Learning in a Blended Agriculture Course	<b>Ryan Rhoades</b> , Boot Chumbley, & Stephanie Peace, Dick & Mary Lewis Kleberg College of Agriculture, TX
86	Students Gain More Knowledge from Hands-On Learning Activities Than Traditional Classroom Lecture	<b>Laura M. White</b> & K.M. Wells, New Mexico State University
81	Teaching Science through a Video Production Course	Rachel DeConna, Katie Stofer, & <b>Ricky Telg</b> , University of Florida
75	Can Student Publications and Conference Presentations be Used as an Assessment Tool?	<b>Sharadchandra P. Marahatta</b> , Valerie H. Henmi, Eman I. Gabour, Robert A. Petersen, Christina C. Martiney, & Jin-Wah Lau, Kaua'i Community College, Lihu'e, HI
53	Recruitment, Training, and Placement of Underrepresented Minorities in Forestry: Lessons from National Needs Master's Fellowship Program	<b>Jacek P. Siry</b> & Pete Bettinger, University of Georgia
52	Quality Seed Leads to a Bountiful Harvest: A Look at Internships	<b>Dana J. Ladner</b> & Kerry Wefald, Kansas Department of Agriculture
36	Development of a Junior Naturalist Curriculum Applicable to all Biogeographical Regions of South Carolina	<b>Mallory K. Dailey</b> , T.R. Dobbins, Christina M. Leard, & A.P. Byrd, Clemson University, SC
34	Using a Professional Certification Program to Cultivate Undergraduate Student Success	<b>Kim J. Kerschen</b> , Dana J. Ladner, & Kevin J. Donnelly, Kansas State University
30	Employment Competencies Desired by Agricultural and Natural Resource Industry Leaders	<b>R.G. (Tre) Easterly III</b> , Anna Warner, Brian Myers, Ricky Telg, & Alexa Lamm, University of Florida



NO.	TITLE	AUTHORS
23	Incorporating Assessment in the Design of a New Interdepartmental Program	<b>Helen Spafford</b> , Teresita Amore, Jonathan Deenik, Yao Hill, Andrew Kaufman, Kenneth Leonhardt, Michael Melzer, Scot Nelson, M'Randa Sandlin, Ania Wieczorek, Mark Wright, & Russell Yost, University of Hawai'i at Mānoa, HI
11	Co-Curricular High Impact Learning Practices: What Are They and How Do We Evaluate and Document Them?	<b>Alan Hansen</b> , Anna Dilger, Nicki Engeseth, Barbara Fiese, Kelly Freeman Bost, David Miller, Robert Schooley, Cory Suski, & Laurie Kramer, University of Illinois at Urbana-Champaign
5	Assessing Knowledge, Performance, and Consequence Competence in a Technology-Based Professional Development for School-Based Agricultural Educators: An Evaluation of the CNC Plasma Cutting Technology Workshop	<b>P. Ryan Saucier</b> & G. Curtis Langley, Sam Houston State University, TX
4	Excitement in the Classroom: An Active Learning Approach Toward Global Sustainability Issues in a Textiles Course	<b>LaPorchia C. Davis</b> , University of Maryland–Eastern Shore
95	Incorporating an Industry Focus Group to Assist in Developing a Master of Agriculture Degree in Sustainable Agriculture and Food Environment	<b>Stanley F. Kelley</b> , Marcy M. Beverly, & Dwayne Pavelock, Sam Houston State University, TX
92	Agripharmatech Student Ambassadors Introduce Advanced Plant Biosciences to Windward Intermediate and High School Students	Ingelia White, <b>Michael Broady</b> , <b>Masami Deschamps</b> , <b>Lia Kim</b> , Hongwei Li, & Teena Michael, Windward Community College, Kāne'ohe, HI
78	Demographic Survey of Animal Science Students Highlights Mismatch Between Experiences and Career Goals	<b>Ryan N. Dilger</b> , Tara L. Felix, & Anna C. Dilger, University of Illinois
74	Exhibitor Evaluation of a Community-Based Agricultural Literacy Program	<b>Kauahi Perez</b> & M'Randa R. Sandlin, University of Hawai'i, Mānoa, HI
72	The Learning Tornado: An Agriscience Comprehension Model	<b>Peter Skelton</b> , <b>Thomas Dormody</b> , & Patricia Dappen, New Mexico State University
40	4-H Afterschool Volunteer Training Program	<b>Abby Coy</b> & Levon T. Esters, Purdue University, IN
38	Internal and External Values Ascribed to College Major Choice by Students of Color in Agriculture and Life Sciences	<b>Rachelle Purnell</b> & James Anderson, Virginia Tech

NO.	TITLE	AUTHORS
32	International Course Development at the Program Level: Collaboration and Student Interest	<b>Tammy M. Bennett</b> & Robert D. Shannon, The Pennsylvania State University
26	Graduate Student Recruitment: Student Perceptions of Recruitment Strategies Utilized by a Southern Land-Grant University	<b>Eric D. Rubenstein</b> & Isis Blanco Vera, University of Georgia
15	Motivating Factors for Student Choice of Major: A Longitudinal Study	<b>Christina Leard</b> , Tom Dobbins, & Dale Layfield, Clemson University, SC
9	Impact of a Short-Term Study Abroad Program on Student Career Interests and Goals	Martellis D. Avent & <b>K.S.U. Jayaratne</b> , North Carolina State University
1	Teaching Assistant Perspectives on a Diversity and Social Justice Education Course for Collegiate Agriculture Students	<b>Shalyse Iseminger</b> , Lisa Young, Eric O'Rear, & Pamala Morris, Purdue University, IN
14	Assessing Curriculum Needs for the 4-H Animal Science Program in Iowa	<b>Amy Powell</b> & Greg Miller, Iowa State University
6	Professional Development Needs of Texas School-Based Agricultural Educators Regarding CNC Plasma Cutting Technology: A Snapshot Assessment Method	G. Curtis Langley & <b>P. Ryan Saucier</b> , Sam Houston State University, TX
114	Mechanical Aptitude of Underrepresented Agricultural Science Majors	<b>Steven Boot Chumbley</b> , Eastern New Mexico University, Portales
184	You Can't Handle the Truth! A Review of Literature of Attitudes of Spouses Toward Family Responsibilities of Agricultural Educators	<b>Dexter Wakefield</b> , Douglas Morrish & Justin Pulley, Texas State University
69	Ask the (Industry) Expert: Using Modified Delphi Survey Techniques as Part of Course and Curriculum Development	<b>Helen Joyner (Melito)</b> , University of Idaho, & Clint Stevenson, North Carolina State University
120	Making Sense out of Food: Sensory Stimulation as an Instructional Approach	<b>Francine Hollis</b> , University of Tennessee
136	Is Diversity on Their Minds? Perceptions of Diversity in an Agriculture Undergraduate Population Using a Multi-Method Survey	<b>Tiffany A. Drape</b> , Gabriel Anderson, Ambrosia Church, Sachi Jain, & Rebekah Slabach, Virginia Tech, Blacksburg
111	Farm Experiences Program: Experiential Learning in Agriculture with Local Farmers and Growers	<b>Kalpalatha Melmaiee</b> , Sathya Elavarthi, & Venu Kalavacharla, Delaware State University
356	Using the Undergraduate Research Course as a Tool to Develop Scientific Proficiency in the University of Puerto Rico - Aguadilla	<b>Yadira Malavez</b> , University of Puerto Rico
201	Teaching Climate Change: An Assessment of Available Educational Materials on Climate Change	<b>Lauri M. Baker</b> , Cassie Wandersee, Katie Rohling, & Peter Tomlinson, Kansas State University

**Group 2A : Innovative Teaching**  
ROOM CC EXECUTIVE DINING ROOM

TIME	NO.	TITLE	AUTHORS
10:25	252	Reflective Narratives Mapped to Learning Objectives Prove More Beneficial than Quizzes	<b>Mark A. Russell</b> & A.E. Baldwin, Purdue University, IN
10:40	251	The Impact of Experiential Learning Dimensions for a Study-Abroad Program on Academic Learning in Food Science	Maria Navarro, Isis O. Blanco Vera, Quint Newcomer, & <b>Ronald B. Pegg</b> , University of Georgia
10:55	242	Facilitating Interdisciplinary Teaching and Learning in Agriculture	<b>Eric Stubbs</b> , Brian Myers, Kathryn Stofer, Laura Warner, & Kirby Barrick, University of Florida
11:10	235	Developing Innovative Student Projects for Comprehensive Review of Course Content	<b>Randall Violett</b> , Southern Utah University
11:25	224	Bringing Microeconomic Theory to Life	<b>Kelly A. Grogan</b> , University of Florida

**Group 2B : Innovative Teaching**  
ROOM CC 203E

TIME	NO.	TITLE	AUTHORS
10:25	216	A SWOT Analysis of the Agriculture Courses for Dual-Credit Initiative	<b>Robert L. Williams</b> , Erin Fortenberry, Maggie Salem, Jackie Wahrmund, Caitlan Holtzman, Texas A&M University, & Shannon Arnold, Montana State University
10:40	214	“Beef It’s What’s For Dinner” Advocacy Service-Learning Project	<b>Brittany J. Howell</b> , Fort Hays State University, KS
10:55	208	Are College Students Too Old for Toys and Games?	<b>Pamela J. Reed</b> , Delaware Valley University
11:10	205	Case-based Gaming for Foodborne Diseases	<b>Kalmia E. Kniel</b> & Adrienne E.H. Shearer, University of Delaware
11:25	198	Integration of Project-Based Learning Into a Summer Bridge Program	<b>Jay Well</b> , Adam Talamantes, Renee O’Neil, & Katharine G. Field, Oregon State University



**IT'S A FACT:** Hawai'i is an agricultural microcosm. It has 11 of the world's 13 climatic zones and multiple soil types.

**Group 2C : Learning Outcomes**  
ROOM CC 307

TIME	NO.	TITLE	AUTHORS
10:25	265	Mission Critical: Enhancing Students' Critical Thinking Skills Through Study Abroad	<b>Gary Wingenbach</b> , William Moore, Ann Martin, Tracy Rutherford, & Tobin Redwine, Texas A&M University, & Wash Jones, Prairie View A & M University
10:40	230	A Baseline for Learning Outcome Assessment: Lessons from Michigan State University	<b>Murari Suvedi</b> & Kelly Millenbah, Michigan State University
10:55	206	Examining the Challenges and Supports Identified by Underrepresented Minority Students Enrolled in STEM Programs within a College of Agriculture	<b>Jonathan J. Velez</b> , Aaron J. McKim, Katherine G. Field, Wanda K. Crannell, Lawrence R. Curtis, Penelope L. Diebel, Dave L. Stone and Katie Gaebel, Oregon State University, & Tyson J. Sorensen, Utah State University
11:10	346	Enhancing Student Learning: Exploring the Potential of Flipped Classrooms	<b>Maria Navarro</b> , University of Georgia
11:25	186	Learning to Write Like a Scientist: A Writing-Intensive Course in a Microbiology Field	<b>Wesley M. Snyder</b> , Katharine G. Field, & Kimi Grzyb, Oregon State University

**Group 2D : Other Educational Topics**  
ROOM CC 308

TIME	NO.	TITLE	AUTHORS
10:25	292	Mentoring a Brighter Future: Retaining Millennial College Students	<b>Shannon Norris</b> , New Mexico State University, Shelly Sitton & Marshall Baker, Oklahoma State University
10:40	291	Community Innovation Lab as a 21st Century Social Science Experiment Station	<b>Kristina Ricketts</b> , <b>Bryan Hains</b> , & Ronald Hustedde, University of Kentucky
10:55	287	Identifying International Agriculture Concepts for School-Based Agricultural Education Curricula	Nathan W. Conner, University of Nebraska- Lincoln, Hailey Gates, Tennessee Technological University, & <b>Christopher T. Stripling</b> , The University of Tennessee
11:10	272	Agroecology as a Tool to Improve Science Capacity In Agriculture Through Participatory Research, Education, and Extension	<b>Alexis Racelis</b> , University of Texas-Rio Grande Valley
11:25	263	Computer Technology Competency Needs for Students Enrolled in Colleges of Agriculture	Puong Huynh, Theresa Pesl Murphrey, & <b>Holli R. Leggette</b> , Texas A&M University

TIME	NO.	TITLE	AUTHORS
10:25	257	Enhancing Student Success in International Programs	Maggie Jo Hansen & <b>Leslie D. Edgar</b> , University of Arkansas
10:40	241	Assessing Student Demographics in a Non-Land Grant Agriculture Program	<b>Maria A. Boerngen</b> , Justin W. Rickard, Stacey M. Lorenz, & Emelia Baker, Illinois State University
10:55	227	Food and Agricultural Education Information System Impact Study on Gender Representation in Colleges of Agriculture and Life Sciences from 2002-2013	<b>Peter Ziegler</b> & Susan Sumner, Virginia Tech
11:10	286	Perceptions Concerning Student-Instructor Interaction using the IDEA Student Evaluation	<b>Mark .J. Anderson</b> , J.L. Leatherwood, K. J. Stutts, M. M. Beverly, & S. F. Kelley, Sam Houston State University
11:25	370	Utilizing Social Network Analysis in a Team-Based Learning Formatted Capstone Course	<b>OP McCubbins</b> , Thomas. H. Paulsen, & Ryan Anderson, Iowa State University

Group 2F : Scholarly Research  
ROOM CC 310

TIME	NO.	TITLE	AUTHORS
10:25	135	Using Concept Map Activities to Show an Increase of Student Knowledge	<b>Jennifer Strong</b> & Barry Boyd, Texas A&M University
10:40	124	Comparison of Teacher Competence in Agricultural Mechanics among Traditionally and Alternatively Certified Agricultural Education Teachers	<b>Robert Frutchey</b> , Ryan Anderson, Thomas H. Paulsen, Iowa State University, & A. Preston Byrd, Clemson University, SC
10:55	122	The Importance of Agricultural Mechanics Skills Training: Implications for Post-Secondary Education	<b>John Rasty</b> & Ryan Anderson, Iowa State University
11:10	99	Promoting Faculty Teaching Excellence and Supporting Student Learning in Colleges of Agriculture	<b>Catherine A. DiBenedetto</b> & Ted Whitwell, Clemson University, SC
11:25	33	Participants' Perceived Importance and Application of Mentoring @ Purdue Program Seminars and Workshops <i>(NEW TIME)</i>	<b>Brandon Allen</b> , Neil A. Knobloch, & Levon T. Esters, Purdue University, IN

Group 3A : Innovative Teaching  
ROOM CC EXECUTIVE DINING ROOM

TIME	NO.	TITLE	AUTHORS
10:15	197	Assessing Agricultural Leadership Academic Programs at 1862 Land-Grant Institutions	<b>Jackson Alexander</b> , K. Jill Rucker, Donna L. Graham, Jefferson D. Miller, & Jason Apple, University of Arkansas
10:30	194	Using Weekly Reflective Academic Journals to Track Learning in Content Heavy Classes	<b>Douglas L. Vincent</b> , University of Hawai'i at Mānoa
10:45	187	Cultivating Effort in Study Abroad: An Innovative Team Teaching Approach	<b>Tobin Redwine</b> , Tracy Rutherford, Gary Wingenbach, Texas A&M University, & Wash Jones, Prairie View A&M University
11:00	183	FFA, Why Are We Here? The Hispanic/Latino Perspective	<b>Dexter Wakefield</b> , Douglas Morrish, Texas State University, & Douglas LaVergne, Texas A&M University - Commerce
11:15	178	Mentoring the Mentor: Supporting Mentor Outcomes in an Innovative College Student Peer Mentoring Program	<b>Kaitlyn A. Murray</b> , Jeffery A. Hattey, & Jeff King, The Ohio State University
11:30	176	Integrating Applied Learning Experiences into an Agricultural Communication Program	<b>T. Wayne Atchley</b> , Diane Taylor, Whit H. Weems, Sandy Graham, & David Frazier, Tarleton State University, TX
11:45	170	Enhancement of Student Engagement and Interaction in Online Courses through Implementation of a Scholar-ignite Program	<b>Brian J. Pearson</b> & Kimberly A. Moore, University of Florida

Group 3B : Innovative Teaching  
ROOM CC 203E

TIME	NO.	TITLE	AUTHORS
10:15	161	Teaching Tools for Agricultural Literacy and Science-Informed Decision-Making	<b>Jenny Daurer</b> , University of Nebraska-Lincoln, NE
10:30	148	Student-Centered Teaching with Problem Based Learning	<b>Xinlei Wang</b> , University of Illinois Urbana-Champaign
10:45	126	Curriculum for a Career Designed Internship	<b>Sandra Graham</b> , Whit Weems, & Wayne Atchley, Tarleton State University, TX

TIME	NO.	TITLE	AUTHORS
11:00	118	Establishing Teaching Efficacy through a Books for Agricultural Education Reading Program	<b>Catherine W. Shoulders</b> , University of Arkansas, & Travis Park, North Carolina State University
11:15	105	Using Video as a Teaching Aid to Help Students Evaluate Themselves in Equitation Classes	<b>Lee Wood</b> , Southern Utah University
11:30	97	Exploring Integration of Research into Teaching at National Agrarian University La Molina, Peru	<b>Carlos Gómez</b> , Silvia Morales, & Jan Elen, University La Molina, Peru
11:45	91	Strengthening Agripharmatech Program through Pathway Certificates and Partnerships with Hi'ilaniwai Food Service and Windward Schools	<b>Ingelia White, Hongwei Li, Teena Michael, &amp; Charlene Akina</b> , Windward Community College, Kāne'ohe, HI

### Group 3C : Innovative Teaching

ROOM CC 307

TIME	NO.	TITLE	AUTHORS
10:15	88	How to Organize and Deliver an Online Class to Meet Student Learning Expectations?	<b>K.S.U. Jayaratne &amp; Gary Moore</b> , North Carolina State University
10:30	84	Breaking News! Using Current Events and Social Media to Teach Power and Influence	<b>Laura Lemons</b> , Mississippi State University, Penny Weeks, Oklahoma State University, & Scott Burris, Texas Tech University
10:45	82	A Pedagogical Approach for "Wicked Problems"	<b>Michelle R. Worosz</b> , Auburn University
11:00	73	Using a University Class to Develop and Test an 8th Grade Climate Science Curriculum	<b>Thomas Dormody, Peter Skelton</b> , Hannah Parker, Tessa Lee, Cassie Jaquez, Dallas Dooley, & Sheldon Church, New Mexico State University
11:15	71	Instructional Techniques that Cultivate Writing Skill Mastery	<b>Holli R. Leggette</b> , Holly Jarvis Whitaker, & Brooke Prather, Texas A&M University
11:30	68	Planning for Success: Student Preflection on the Impacts of Behavioral Styles on the Success of a Course Project	<b>M'Randa R. Sandlin &amp; Melissa R. Price</b> , University of Hawai'i at Mānoa, HI
11:45	66	Picture This! Using Images to Stimulate Nonlinguistic Reflection in Undergraduate Agriculture Courses	<b>Carley Calico</b> , Laura Lemons, Mississippi State University, & Catherine W. Shoulders, University of Arkansas



**IT'S A FACT:** Agtourism is a \$1.1 million industry for Hawai'i.

### Group 3D : Learning Outcomes

ROOM CC 308

TIME	NO.	TITLE	AUTHORS
10:15	167	Assessment of Strengths-Based Leadership Domains and Their Impact on Student Academic Success	<b>Deborah L. VanOverbeke &amp; Amy R. Gazaway</b> , Oklahoma State University
10:45	157	Creating Learning Outcomes and Rubrics for Education Abroad	<b>Kelly A. Newlon &amp; Kelly A. George</b> , The Ohio State University
11:00	143	Cultivating Advocacy Skills and Content Knowledge: An Evaluation of a Course Project	<b>Carrie L. Pickworth &amp; Wendy J. Warner</b> , North Carolina State University
11:15	90	Cultivating Successful Participation and Outcomes in International Experiences: Students' Evaluation of the Pre-Departure Course for Study Abroad	<b>Jan D. Brooks &amp; Sarai Coba-Rodriguez</b> , University of Illinois Urbana-Champaign
11:30	85	Knowledge Gain and Student Perception of Experiential Learning Activities	<b>Laura M. White &amp; K.M. Wells</b> , New Mexico State University
11:45	64	A College-Wide Project to Improve Student Writing	<b>Tom Dormody</b> , Keith Mandabach, David Cowley, Ram Acharya, Ryan Goss & Dawn VanLeeuwen, New Mexico State University

### Group 3E : Other Educational Topics

ROOM CC 309

TIME	NO.	TITLE	AUTHORS
10:15	202	Extension Program Planning: Volunteer Perceptions of the Purpose of Extension Program Area Committees <b>(CANCELLED)</b>	<b>Whit H. Weems</b> , Tarleton State University, TX, Chris T. Boleman, Texas A & M Extension, & David E. Lawver, Texas Tech University
10:30	195	Creation and Implementation of a Campus-wide Grant Award Program Recognizing Whole Departments for Excellence In Education	<b>Don Mulvaney &amp; Jim Groccia</b> , Auburn University, AL

TIME	NO.	TITLE	AUTHORS
10:45	181	Cultivating Faculty Success Through the Peer Review of Teaching	<b>Anne Spafford</b> , Bryce Lane, & Wendy Warner, North Carolina State University
11:00	168	Teaching-Mentoring Experiences of Faculty in a College of Agriculture and Life Sciences	<b>Wendy J. Dahl</b> , Ricky W. Telg, Anthony C. Andenoro, Michael G. Andreu, Xin Zhao, & R. Elaine Turner, University of Florida
11:15	166	Some Observations Relative to Entering First Year Students Majoring in Animal Science	<b>Michael O. Smith</b> , University of Tennessee
11:30	165	Outcomes and Experiences of Students Participating in an International Horsemanship Program	<b>Jessica L. Leatherwood</b> , M. M. Beverly, M. J. Anderson, K. J. Stutts, & S. F. Kelley, Sam Houston State University, TX
11:45	155	Homeschooled Students' Access to Participate in School-based Agricultural Education Programs	Matthew Kararo & <b>Neil Knobloch</b> , Purdue University, IN

### Group 3F : Scholarly Research

ROOM CC 310

TIME	NO.	TITLE	AUTHORS
10:15	87	Student Motivation and Valuing of Active Learning Strategies in Large Lecture Agricultural Undergraduate Courses	<b>Amanda Bowling</b> , John Tummons, & Anna Ball, University of Missouri
10:30	79	Finding Balance in Undergraduate Research for Graduate School and Career Preparation in Agricultural Sciences	<b>Shad D. Nelson</b> , Randy Stanko, Tanner Machado, Greta Schuster, & Consuelo Donato-Molina, Texas A&M University
10:45	70	Using Curriculum Mapping and Assessment Techniques to Evaluate a Food Science Curriculum	<b>Helen Joyner (Melito)</b> , University of Idaho
11:00	67	Listening and the Agricultural Workforce	<b>Laura Hasselquist</b> & Tracy Kitchel, University of Missouri
11:15	47	Intentional Reflective Practice to Wrap-up the Semester	<b>Ann Marie VanDerZanden</b> , Iowa State University
11:30	25	A Model to Predict a Student's Intention to Study Abroad	<b>Melissa Hendrickson</b> , Elizabeth Wilson, Jay Jayaratne, & Wendy Warner, North Carolina State University
11:45	311	Not Just Another Webinar: Innovation in Online Professional Development	<b>Daniel Foster</b> & Melanie Miller Foster, The Pennsylvania State University

## friday 1:30–2:45 p.m. Concurrent Presentations 4

### Group 4A : Innovative Teaching

ROOM CC EXECUTIVE DINING ROOM

TIME	NO.	TITLE	AUTHORS
1:30	56	Novel Education Abroad Experience Via Advanced Seminar Course Structure	<b>Soo-Yeun Lee</b> , Prasanta Kalita, Kim Graber, & Laurie Kramer, University of Illinois at Urbana-Champaign
1:45	55	A Picture's Worth a Thousand Words: Using Images to Engage Online and On-campus Students in Meaningful Reflection	<b>Catherine W. Shoulders</b> , University of Arkansas, & Carley Calico, Mississippi State University
2:00	51	Cultivating Student Learning through Undergraduate Interdisciplinary Research: Creative Inquiry	Christina Leard, <b>Jesse Blount</b> , & Tom Dobbins, Clemson University, SC
2:15	45	Student Reflections on Service-Learning in a Greenhouse Hydroponic Food Production Course	Christopher J. Currey & <b>Ann Marie VanDerZanden</b> , Iowa State University
2:30	42	Augmenting Reality in a Plant Science Lab	<b>Christian M. Baldwin</b> & Gaea Hock, Mississippi State University

### Group 4B : Innovative Teaching

ROOM CC 203E

TIME	NO.	TITLE	AUTHORS
1:30	41	Compound Teaching and Learning	<b>Dennis R. Buckmaster</b> , Purdue University, IN
1:45	29	Producing Teachers with a Balance of Content and Pedagogical Knowledge: Recommendations for Success	<b>Eric D. Rubenstein</b> , Nicholas E. Fuhrman, Amber H. Rice, & Frank B. Flanders, University of Georgia
2:00	28	Small Animals in the College Classroom: Student Reactions and Educator Recommendations	<b>Nicholas E. Fuhrman</b> & Eric D. Rubenstein, University of Georgia
2:15	21	Developing Project Based Learning for Agricultural Systems Technology Courses	<b>Michael L. Pate</b> , Kelsey Hall, Bruce E. Miller, F. Richard Beard, & Royce Hatch, Utah State University
2:30	20	Bee Smart: The Buzz on Pollination and Pollinators	<b>Kellie Taguchi</b> & Charles Kinoshita, University of Hawai'i, Mānoa, HI

**Group 4C : Innovative Teaching**

ROOM CC 307

TIME	NO.	TITLE	AUTHORS
1:30	18	The Use of a Learning Game: Trot to Trophy, in Equine Science	<b>Shannon Pratt-Phillips</b> , North Carolina State University
1:45	306	Service Knowledge Gained from Service Learning in an Undergraduate Sales Class	<b>W. Scott Downey</b> , Purdue University, IN
2:00	3	Census of Baccalaureate Agriculture Teacher Education Programs in the United States	<b>R.G. (Tre) Easterly III</b> , Brian E. Myers, University of Florida, & Christopher T. Stripling, University of Tennessee
2:15	2	Mexican Agriculture Students Learn about the United States Cooperative Extension Model	<b>Maria G. Fabregas Janeiro</b> , University of California, & Jorge H. Atilas, Oklahoma State University
2:30	158	The Effects of an Introductory Agriculture Curriculum on Student Knowledge and Perceptions of Agriculture <i>(NEW TIME)</i>	Timothy Bradford Jr., Gaea Hock, <b>Laura Lemons</b> , & Alayna Naro, Mississippi State University

**Group 4D : Learning Outcomes**

ROOM CC 308

TIME	NO.	TITLE	AUTHORS
1:30	61	Creating a Cadre of Critical Thinking Scholars	<b>Kim Dooley</b> , Jenna Kurten, & Barry Boyd, Texas A&M University
1:45	43	ShortKeys: The Key to Efficient Grading Online	<b>Matt Kennedy</b> , Oregon State University
2:00	31	Learning Outcomes Assessment: Can Engaged Scholarship Experiences Improve Student Learning?	<b>Robert D. Shannon</b> & Tammy M. Bennett, The Pennsylvania State University
2:15	27	Addressing Food Insecurity via a Participatory Approach to International Service Learning	<b>Dennis W. Duncan</b> , Nicholas Fuhrman, & Eric Rubenstein, University of Georgia
2:30	12	Is an Online Gathering Place Important for Distance Education Student Success? A Comparison of the Perceptions of Online Professors and Students	<b>Gary Moore</b> , Wendy Warner, David Jones, North Carolina State University, & Jane Bachelor, University of Florida



**IT'S A FACT:** Hawai'i aquaculture has a market value of \$56 million, according to the latest USDA census.

**Group 4E : Other Educational Topics**

ROOM CC 309

TIME	NO.	TITLE	AUTHORS
1:30	116	Influences in Students Choosing Majors in Agriculture	<b>Willa Williams</b> , University of Missouri, & Linda Okiror, University of Arkansas at Pine Bluff
1:45	96	Student Definition and Perception of Sustainable Agriculture	<b>Marcy M. Beverly</b> , Stanley F. Kelley, Philip Urso, & Cody Wellmann, Sam Houston State University, TX
2:00	35	Online Management of Experiential Learning Process and Grading	Paul D. Siciliano & <b>Jeannette A. Moore</b> , North Carolina State University
2:15	225	Connecting with Students: Online Tools to Help with Retention	<b>Lauri M. Baker</b> , Brooke Harshaw, & Kristina Boone, Kansas State University

**Group 4F : Other Educational Topics / Scholarly Research**

ROOM CC 310

TIME	NO.	TITLE	AUTHORS
1:30	22	Farmers' Utilization of Auto-guidance Technology and Training Needs	Thomas Bleazard, <b>Michael L. Pate</b> , Rebecca G. Lawver, Clark Israelsen, & Royce Hatch, Utah State University
1:45	150	Agricultural Education Pre-service Teachers' Perceived Competence in an Advanced Agricultural Mechanics Course	<b>John C. Ewing</b> & Rama Radhakrishna, The Pennsylvania State University
2:00	17	Use of Supplementary Materials in a Distance Education Equine Science Class	<b>Shannon Pratt-Phillips</b> & Taylor Knittel, North Carolina State University
2:15	10	Major Commitment as a Predictor of Student Success	<b>Rachel Jackson</b> , Cindy Akers, David Doerfert, Todd Brashears, Erica Irlbeck, & Troy Tarpley, Texas Tech University
2:30	234	Student Interest is the Strongest Determinant of Success in Introductory College Courses Related to Environmental Science	<b>Nick J. Balster</b> , Melanie A. Spero, & Mark Banghart, University of Wisconsin-Madison



**IT'S A FACT:** From lavender to exotic florals, Hawai'i nurseries and greenhouses generate \$80 million. Floriculture helped diversify post-plantation agriculture.

#### WORKSHOP 1: EXECUTIVE DINING ROOM

##### *USDA-Sponsored Workshop* — **Boosting Student Enrollment: Successful Recruitment Courses in Food and Agricultural Sciences**

*Facilitator: Maria Stewart, University of Hawai‘i at Mānoa*

*Panelists: Dr. Thomas Famula, University of California, Davis*

Student recruitment and enrollment in food and agricultural science degree programs is a priority at many institutions. Because many college students are unaware of careers in food and agricultural sciences, their first exposure to these careers and fields of study may be in introductory level courses such as “Humans, Animals, and Agriculture,” “The Science of Human Nutrition,” and “Tropical Crop Science.” This workshop will provide examples of how food and agricultural degree programs attract students to their courses, such as fulfilling a general education requirement. This workshop will address instructional strategies for the classroom to attract and retain students in food and agricultural sciences. The workshop will include brief presentations by invited speakers followed by a panel discussion.

#### WORKSHOP 2: CC 203E

##### **Teaching Indigenous Agriculture: Hawaiian Approaches to Integrate Traditional Crops and Cropping Systems in Today’s Training Programs and Curricula**

*Facilitator: Tiare Silvasy, University of Hawai‘i at Mānoa*

Living in a remote island, the indigenous people of Hawai‘i knew that the health of the ‘āina (land) is central to the health of the people. As such, cultural and ‘āina based learning are strongly represented in post-secondary curriculum. The Hawaiians managed their agricultural systems in a highly advanced manner because of their intimate knowledge of the land and their ability to cultivate their crops in diverse environments. There is a dedicated effort to keep these indigenous agricultural practices alive in both agricultural and Hawaiian studies programs. In this workshop you will learn unique strategies being used to teach indigenous agricultural practices in Hawai‘i, as well as the benefits to the learners, the community and the land. This workshop will also include interactive group activities to explore how to further cultural and ‘āina-based teaching approaches.



#### WORKSHOP 3: CC 307

##### **Quality Seed Variety Leads to a Bountiful Harvest: A Look at Internships**

*Facilitator: Dana Minihan Ladner, Kansas Department of Agriculture*

Experiential learning opportunities, to include internships, are viewed as valuable tools for undergraduate student success. A variety of quality seeds are required for a bountiful student experience to include: interested students, faculty advisors, administrators, career services personnel, and industry partners. This workshop discusses internships across disciplines. Findings from a January 2016 survey to NACTA members will be presented. An employer panel will follow to discuss the significance of internships and a round-table dialogue will cover the value of internships from an academic perspective.

#### WORKSHOP 4: CC 308

##### **Assessment – Not a 4-Letter Word! Meaningful and Manageable Strategies for Assessing Student Learning Outcomes**

*Facilitator: Karen Cachevki Williams, University of Wyoming, Laramie*

Student learning outcomes for undergraduate and graduate student programs can be challenging to create and even more challenging to assess. This workshop will begin by defining student learning outcomes and show how they can be created based on what your course or program finds most meaningful. It will then progress to look at how to make decisions about approaches to assessment, including how to write or use rubrics (such as AAC& U’s VALUE Rubrics) for assessing student learning outcomes. Examples and case studies will be shared from programs in the University of Wyoming College of Agriculture and Natural Resources and other campus programs. Attendees are encouraged to bring course, program, and/or college student learning outcomes for discussion and small group work sessions.

#### WORKSHOP 5: CC 309

##### **Advancing Your Scholarly Teaching into the Scholarship of Teaching and Learning (SoTL)**

*Facilitators: Ann Marie VanDerZanden and Cindy Haynes, Iowa State University*

Scholarly teaching focuses on student learning. It is grounded in the subject matter being taught and in the implementation of effective pedagogies. The overarching objective of this workshop is to outline a framework and provide a stepwise process to guide faculty in developing a publishable scholarship of teaching project. Upon completion of the

workshop participants will have: 1) identified and developed a researchable question; 2) developed a framework and protocol for data collection; and 3) completed a project timeline including milestones.

## WORKSHOP 6: CC 310

### Strategic Study Abroad Course Development and Assessment

Facilitator: *Laura White, New Mexico State University*

Meaningful international study programs should include two components. First, the U.S. participants should develop new competence in global agricultural education. Equally important is how the program will have a positive effect on the non-U.S. institution and people, addressing what we leave behind for their betterment and hopefully avoiding the “ugly American” syndrome of taking advantage of the host institution and “we are from the U.S. and we are here to tell you what to do.” This presentation will address five major components of a successful international agricultural education program engagement: 1) Developing the course and the in-country experience, 2) Recruiting and selecting participants, 3) Orientation, 4) Travel and in-country activities, and 5) Assessing learning, including knowledge gain, reflection, and post-travel dissemination activities. Two programs will be highlighted to give multiple perspectives.



## Conference Planning Committee

Thank you to UH System employees for their work in planning this year's NACTA Conference.

**Charles Kinoshita, Committee Chair**  
College of Tropical Agriculture and Human Resources  
University of Hawai'i at Mānoa

**Ingelia White**  
Department of Natural Sciences  
Windward Community College

**Ronald Takahashi**  
Culinary Arts Program  
Kapi'olani Community College

**College of Tropical Agriculture and Human Resources staff members:**

**Steven Chiang**  
Agribusiness Incubator Program

**Kellie Taguchi**  
**Joel Bumanglag**  
**Mandy Chen**  
Academic and Student Affairs

**Cheryl Ernst**  
Communication Services



**'ĀINA** (*land*) comes from the Hawaiian word 'ai (*to eat*) because it is the land that feeds us.

## COLLEGE OF TROPICAL AGRICULTURE AND HUMAN RESOURCES PEOPLE, PLACE, PROMISE SINCE 1907

### All in the 'Ohana



The professional organization named CTAHR PhD student **Emily Teng** one of just six HortScholars in the nation. She does research on poinsettia pigmentation to help local growers.

### All in the 'Ohana



CTAHR alumnus and Small Business Administration Young Entrepreneur of the Year **Sean Aukanaii Fong** sells grasses requiring less water and fertilizer and grown on composted green waste.

### All in the 'Ohana



**Chino Cabalteja**, now a PhD candidate at the University of Pittsburgh, won UH Mānoa's top student research award. He evaluated cone snail toxin peptides for potential new pesticides and pharmaceuticals.



**'AHUPUA'A** Native Hawaiians identified wedge-shaped land divisions from mountain crest into the sea that were self-sustaining, with interrelated elements and beings.



## CONFERENCE AT A GLANCE

6.21 *tues.*

11 AM - 3 PM  
**NACTA EXECUTIVE  
COMMITTEE  
MEETING**  
UHM CC 307

4:30 - 6:30 PM  
**REGISTRATION**  
KAPĪ'OLANI  
COMMUNITY COLLEGE

5:30 - 7:30 PM  
**WELCOME  
RECEPTION**  
KAPĪ'OLANI  
COMMUNITY COLLEGE

9:45 AM - 12 PM  
**CONCURRENT  
PRESENTATIONS**  
UHM CAMPUS CENTER

12 - 1 PM  
**LUNCH (VOUCHERS)**  
UHM CAMPUS CENTER

1 - 3:10 PM  
**POSTER SESSION**  
UHM CC BALLROOM

6 - 9 PM  
**LŪ'AU**  
WINDWARD  
COMMUNITY COLLEGE

10:25 - 11:40 AM  
**CONCURRENT  
PRESENTATIONS**  
UHM CAMPUS CENTER

11:40 AM - 12:30  
PM  
**BOX LUNCH**  
UHM CAMPUS CENTER  
BALLROOM

12:30 - 6 PM  
**TOURS**  
DEPART FROM UHM

10:15 AM - 12 PM  
**CONCURRENT  
PRESENTATIONS**  
UHM CAMPUS CENTER

12 - 1:30 PM  
**NACTA BUSINESS  
LUNCHEON**  
UHM CC BALLROOM

1:30 - 2:45 PM  
**CONCURRENT  
PRESENTATIONS**  
UHM CAMPUS CENTER

3 - 5 PM  
**WORKSHOPS**  
UHM CAMPUS CENTER

5:30 - 8:30 PM  
**NETWORKING  
& AWARDS  
BANQUET**  
UHM CAMPUS CENTER  
BALLROOM

6.22 *wed.*

7:30 AM - 3 PM  
**REGISTRATION**  
UHM CC BALLROOM  
FOYER

7:30 - 8 AM  
**BREAKFAST**  
UHM CC BALLROOM

8 - 9:30 AM  
**OPENING SESSION**  
UHM CC BALLROOM

7:30 AM - 12 PM  
**REGISTRATION**  
UHM CC BALLROOM  
FOYER

7:30 - 8 AM  
**BREAKFAST**  
UHM CC BALLROOM

8 - 10:10 AM  
**POSTER SESSION**  
UHM CC BALLROOM

7:30 - 9 AM  
**REGISTRATION**  
UHM CAMPUS CENTER  
BALLROOM FOYER

7:30 - 9 AM  
**BREAKFAST  
AND NACTA  
COMMITTEE  
MEETINGS**  
UHM CC BALLROOM

9 - 10 AM  
**BLUE-RIBBON  
PRESENTATION**  
UHM CC BALLROOM

6.24 *fri.*

6.25 *sat.*

9 - 12 PM  
**NACTA EXECUTIVE  
COMMITTEE  
MEETING**  
ALA MOANA HOTEL

FOR DETAILED SCHEDULE, SEE PAGE 8

SAVE THE DATE:



June 28-July 1, 2017

- INnovation,
- IN Learning,
- IN the Heartland



[www.conf.purdue.edu/NACTA2017](http://www.conf.purdue.edu/NACTA2017)